

Soils Map

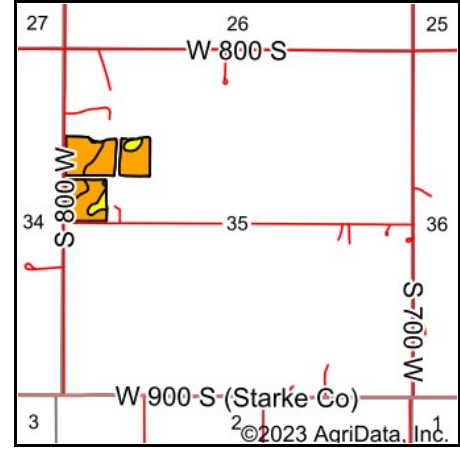

State: **Indiana**
 County: **Starke**
 Location: **35-32N-4W**
 Township: **Railroad**
 Acres: **24.38**
 Date: **4/4/2023**

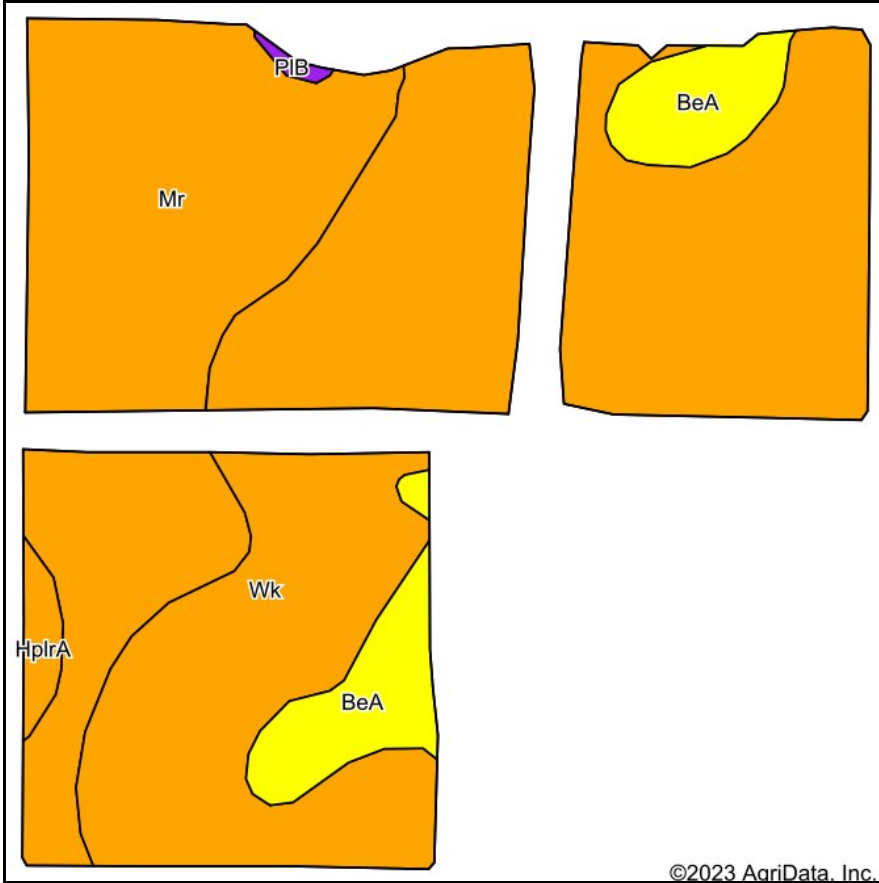

Maps Provided By:



Soils data provided by USDA and NRCS.

©2023 AgriData, Inc.

© AgriData, Inc. 2023

www.AgriDataInc.com

Area Symbol: IN149, Soil Area Version: 24

Code	Soil Description	Acres	Percent of field	Non-Irr Class Legend	Water Table	Restrictive Layer	Soil Drainage	Non-Irr Class *c	Corn Bu	Soybeans Bu	Wheat Bu	Winter wheat Bu	*n NCCPI Corn	*n NCCPI Soybeans
Wk	Watseka loamy sand	14.00	57.4%		1.2ft.	> 6.5ft.	Somewhat poorly drained	IIIs	104	27		47	33	33
Mr	Morocco loamy sand, 0 to 2 percent slopes	7.95	32.6%		1ft.	> 6.5ft.	Somewhat poorly drained	IIIs	102	36	38	3	48	31
BeA	Brems sand, 0 to 3 percent slopes	2.07	8.5%		2.2ft.	> 6.5ft.	Moderately well drained	IVs	81	29		37	24	26
HplrA	Houghton muck, drained, prairie peninsula, 0 to 1 percent slopes	0.30	1.2%		0ft.	> 6.5ft.	Very poorly drained	IIIw	154	54		61	91	88
PIB	Plainfield sand, 2 to 6 percent slopes	0.06	0.2%		> 6.5ft.	> 6.5ft.	Excessively drained	VIIs	73	25		29	35	25
Weighted Average								3.09	101.9	30.4	12.4	31.9	*n 37.8	*n 32.4

*n: The aggregation method is "Weighted Average using all components"

*c: Using Capabilities Class Dominant Condition Aggregation Method

Soils data provided by USDA and NRCS.