

# Soils Map

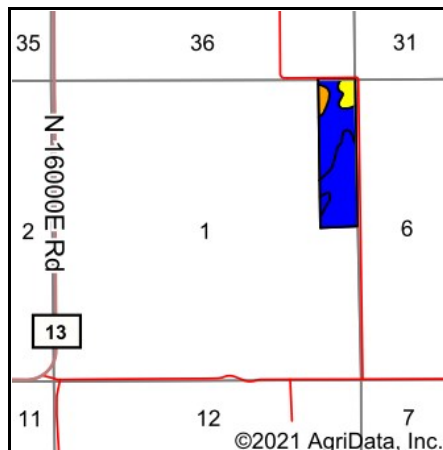

State: **Illinois**  
 County: **Kankakee**  
 Location: **1-31N-14E**  
 Township: **Momence**  
 Acres: **39.75**  
 Date: **8/12/2021**

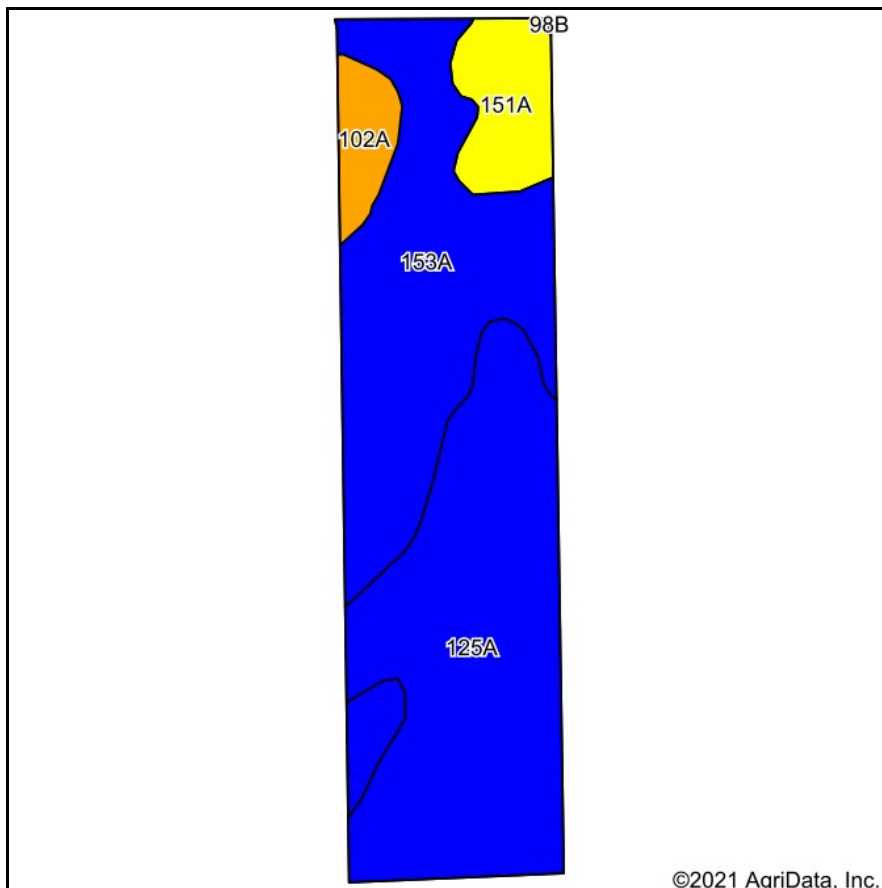

Area Symbol: IL091, Soil Area Version: 17

Code	Soil Description	Acres	Percent of field	Il. State Productivity Index Legend	Water Table	Restrictive Layer	Soil Drainage	Subsoil rooting <sup>a</sup>	Corn Bu/A	Soybeans Bu/A	Wheat Bu/A	Grass-legume hay, T/A	Crop productivity index for optimum management
125A	Selma loam, 0 to 2 percent slopes	18.82	47.3%	Blue	0.5ft.	> 6.5ft.	Poorly drained	FAV	176	57	70	6.38	129
153A	Pella silty clay loam, 0 to 2 percent slopes	15.79	39.7%	Blue	0.5ft.	> 6.5ft.	Poorly drained	FAV	183	60	70	5.27	136
151A	Ridgeville fine sandy loam, 0 to 2 percent slopes	3.33	8.4%	Yellow	1.5ft.	> 6.5ft.	Somewhat poorly drained	FAV	151	51	63	5.02	114
102A	La Hogue loam, 0 to 2 percent slopes	1.81	4.6%	Orange	1.5ft.	> 6.5ft.	Somewhat poorly drained	FAV	162	52	71	5.27	121
<b>Weighted Average</b>									<b>176</b>	<b>57.5</b>	<b>69.5</b>	<b>5.77</b>	<b>130.2</b>

**Table: Optimum Crop Productivity Ratings for Illinois Soil by K.R. Olson and J.M. Lang, Office of Research, ACES, University of Illinois at Champaign-Urbana.** Version: 1/2/2012 Amended Table S2 B811

Crop yields and productivity indices for optimum management (B811) are maintained at the following NRES web site:

<http://soilproductivity.nres.illinois.edu/>

\*\* Indexes adjusted for slope and erosion according to Bulletin 811 Table S3

<sup>a</sup> UNF = unfavorable; FAV = favorable

<sup>e</sup> Soils in the well drained group were not rated for grass-legume and are shown with a zero "0".