

Soils Map

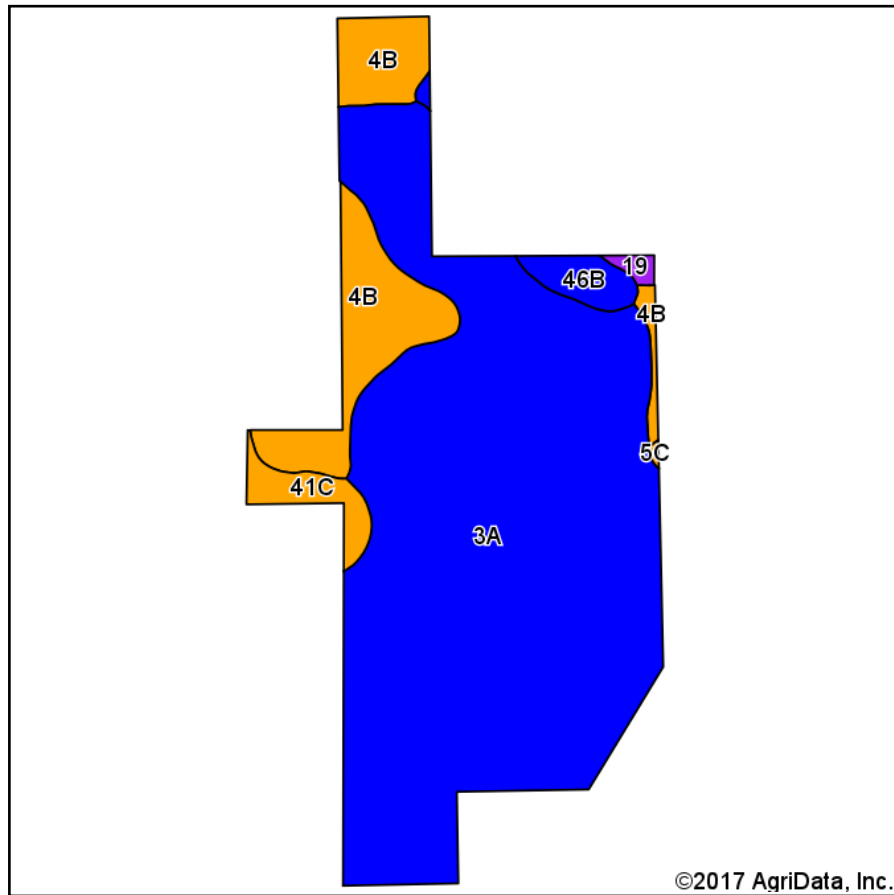

Soils data provided by USDA and NRCS.

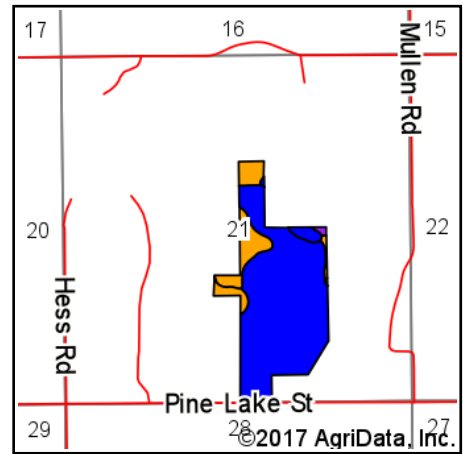

State: **Michigan**
 County: **Cass**
 Location: **21-7S-15W**
 Township: **Jefferson**
 Acres: **82.96**
 Date: **2/13/2017**



Maps Provided By:



© AgriData, Inc. 2017

www.AgriDataInc.com



Area Symbol: MI027, Soil Area Version: 12

Code	Soil Description	Acres	Percent of field	Non-Irr Class Legend	Water Table	Soil Drainage	Non-Irr Class *c	Irr Class *c	Alfalfa hay	Alfalfa hay Irrigated	Corn	Corn Irrigated	Corn silage	Corn silage Irrigated	Oats	Soybeans	Soybeans Irrigated	Winter wheat
3A	Schoolcraft loam, 0 to 2 percent slopes	67.77	81.7%		> 6.5ft.	Well drained	Ils	Ils	4.8	9	135	180	19	28	95	35	55	6
4B	Oshtemo sandy loam, 2 to 6 percent slopes	10.66	12.8%		> 6.5ft.	Well drained	IIIs	IIle	3.5	8	100	175	10	27	80	30	57	4
41C	Spinks-Oshtemo complex, 6 to 12 percent slopes	2.13	2.6%		> 6.5ft.	Well drained	IIle	IIle			68	155	12	23	55	23	50	3
46B	Cassopolis fine sandy loam, 3 to 6 percent slopes	1.92	2.3%		4.5ft.	Moderately well drained	Ile		4.6		115		18			40		4
19	Houghton muck, 0 to 1 percent slopes	0.41	0.5%		0ft.	Very poorly drained	Vw											
5C	Spinks loamy sand, 6 to 12 percent slopes	0.07	0.1%		> 6.5ft.	Well drained	IIle	IIle										
Weighted Average									4.5	8.4	127.5	173.5	17.5	26.9	89.3	34	53.5	56

Area Symbol: MI027, Soil Area Version: 12

*c: Using Capabilities Class Dominant Condition Aggregation Method

Soils data provided by USDA and NRCS.