

Soils Map

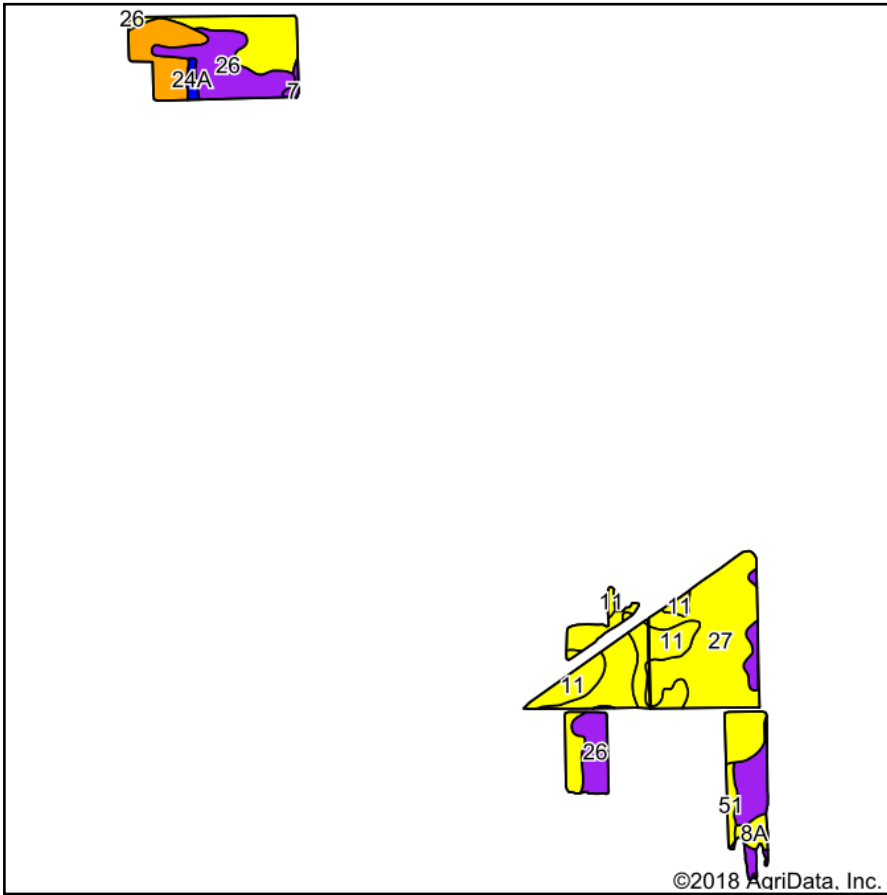

Soils data provided by USDA and NRCS.

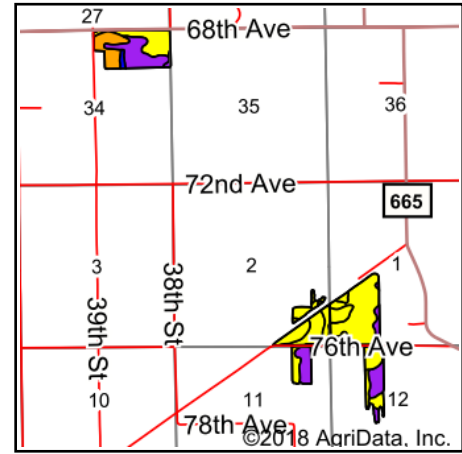

State: **Michigan**
 County: **Van Buren**
 Location: **2-4S-14W**
 Township: **Decatur**
 Acres: **238.53**
 Date: **5/30/2018**



Archived Soils Ending 2/5/2014

Code	Soil Description	Acres	Percent of field	Non-Irr Class Legend	Non-Irr Class *c	Irr Class *c	Alfalfa hay	Alfalfa hay Irrigated	Corn	Corn Irrigated	Corn silage	Corn silage Irrigated	Oats	Soybeans	Soybeans Irrigated	Winter wheat	NCCPI Overall
27	Adrian muck	120.84	50.7%		IVw				100		17			32			66
26	Gilford sandy loam	56.56	23.7%		Vw												28
11	Edwards muck	30.20	12.7%		IVw				95		16			34			76
20B	Spinks loamy sand, 0 to 6 percent slopes	19.60	8.2%		IIIs	IIIs			75	165	13	24	60	27	50	30	26
8A	Morocco loamy sand, 0 to 2 percent slopes	4.31	1.8%		IVs				80		9		45	28		36	25
51	Kingsville loamy sand	3.58	1.5%		IVw				75		12		70	25		30	41
24A	Bronson sandy loam, 0 to 3 percent slopes	2.05	0.9%		IIs	IIs	4	9	100	170	17	27	80	30	55	40	66
7	Glendora sandy loam	1.39	0.6%		VIw												12
Weighted Average							*-	0.1	72.3	15	12.2	2.2	7.5	23.9	4.6	3.9	53.5

*c: Using Capabilities Class Dominant Condition Aggregation Method

Soils data provided by USDA and NRCS.