

Soils Map

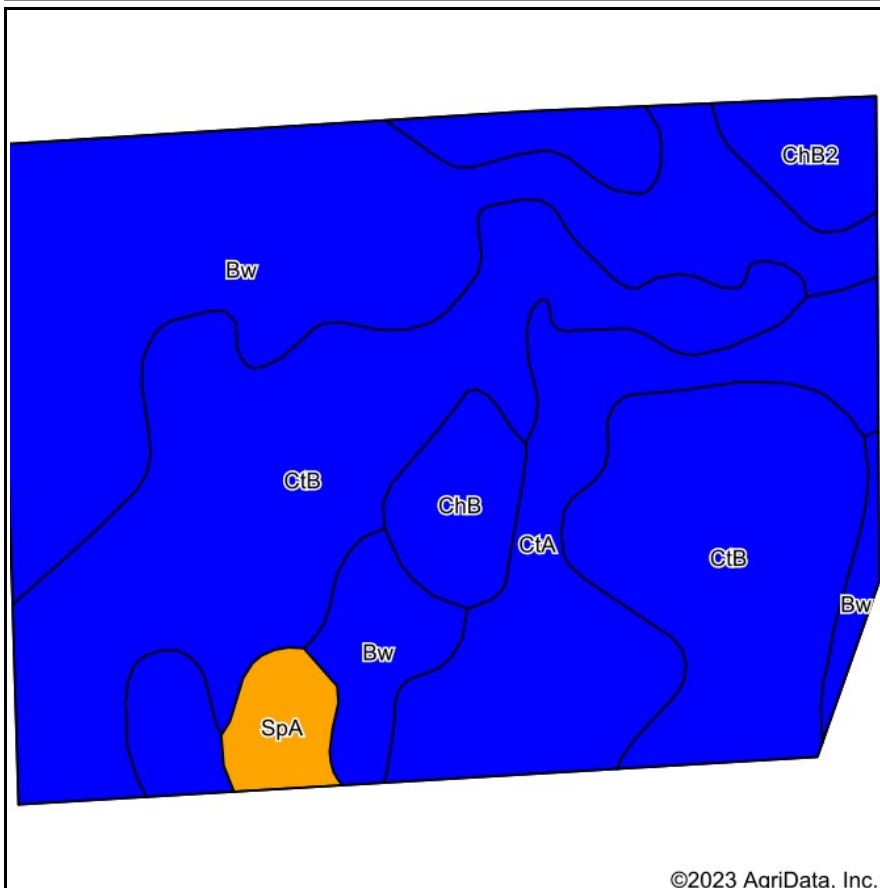

©2023 AgriData, Inc.

Soils data provided by USDA and NRCS.

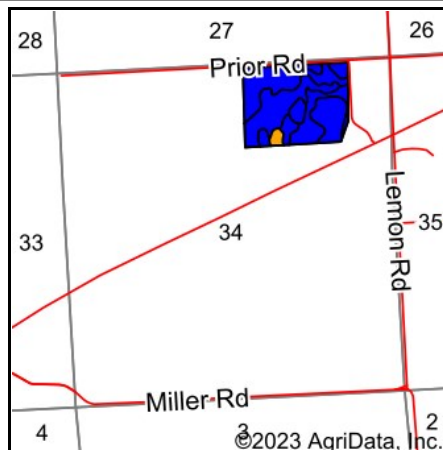

©2023 AgriData, Inc.

State: **Michigan**
 County: **Shiawassee**
 Location: **34-6N-3E**
 Township: **Shiawassee**
 Acres: **48.04**
 Date: **5/9/2023**



Maps Provided By:



© AgriData, Inc. 2023

www.AgriDataInc.com



Archived Soils Ending 1/21/2012

Code	Soil Description	Acres	Percent of field	Non-Irr Class Legend	Water Table	Restrictive Layer	Soil Drainage	Non-Irr Class *c	Irr Class *c	Corn Bu	Soybeans Bu	Winter wheat Bu
CtB	Conover loam, 2 to 6 percent slopes	19.35	40.3%		0.5ft.	> 6.5ft.	Somewhat poorly drained	Ile		143	40	71
B w	Brookston loam	15.53	32.3%		0ft.	> 6.5ft.	Poorly drained	IIw		154	45	71
CtA	Conover loam, 0 to 2 percent slopes	7.74	16.1%		0.5ft.	> 6.5ft.	Somewhat poorly drained	IIw		143	40	71
ChB2	Celina loam, 2 to 6 percent slopes, moderately eroded	2.51	5.2%		1.5ft.	> 6.5ft.	Moderately well drained	Ile		120	32	60
ChB	Celina loam, 2 to 6 percent slopes	1.78	3.7%		1.5ft.	> 6.5ft.	Moderately well drained	Ile		132	35	66
SpA	Spinks loamy sand, 0 to 2 percent slopes	1.13	2.4%		> 6.5ft.	> 6.5ft.	Well drained	IIIs	IIIs	88	25	33
Weighted Average								2.02	*-	143.7	40.7	69.3

*c: Using Capabilities Class Dominant Condition Aggregation Method

*- Irr Class weighted average cannot be calculated on the current soils data due to missing data.