

Soils Map

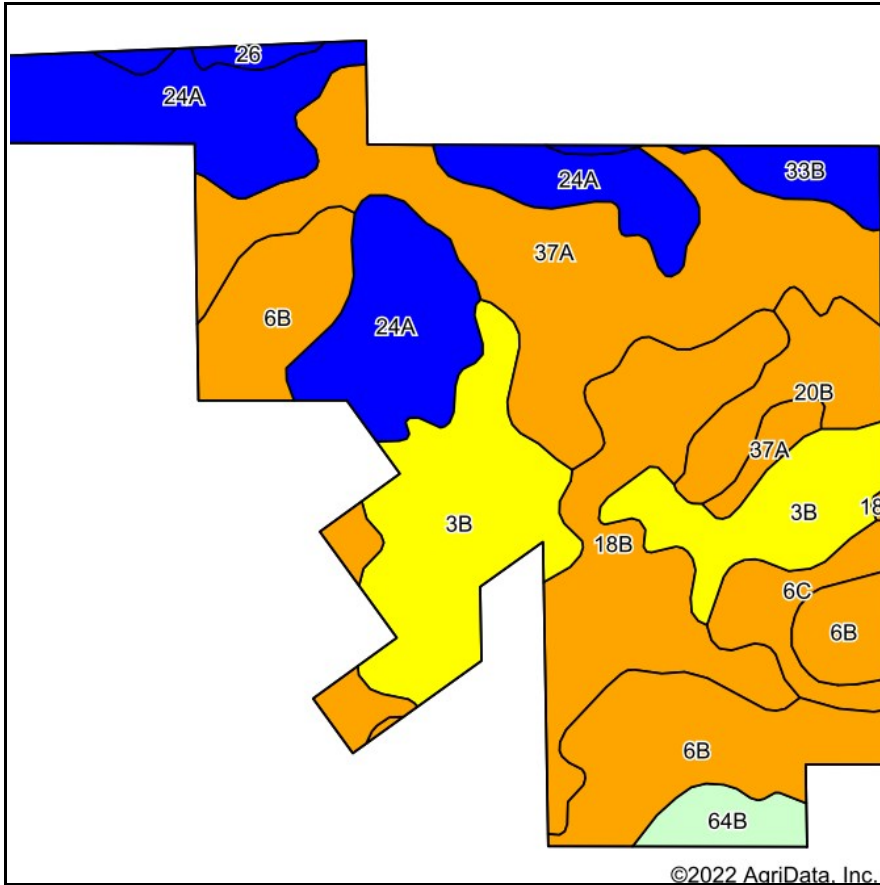

Soils data provided by USDA and NRCS.

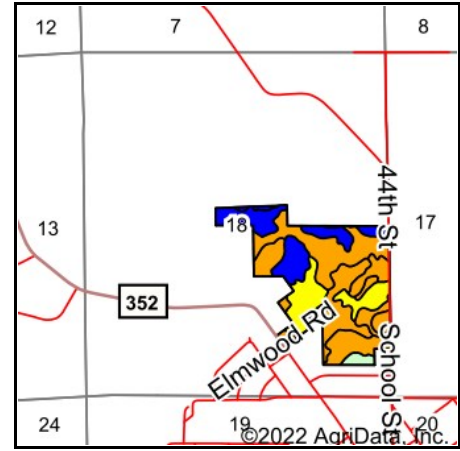

State: **Michigan**
 County: **Van Buren**
 Location: **18-4S-14W**
 Township: **Decatur**
 Acres: **85.28**
 Date: **5/19/2022**



Maps Provided By:



© AgriData, Inc. 2021

www.AgrDataInc.com



Area Symbol: MI159, Soil Area Version: 17

Code	Soil Description	Acres	Percent of field	Non-Irr Class Legend	Soil Drainage	Non-Irr Class *c	Irr Class *c	Corn Bu	Corn Irrigated Bu	Soybeans Bu	Soybeans Irrigated Bu	*n NCCPI Overall	*n NCCPI Corn	*n NCCPI Soybeans
37A	Thetford loamy sand, 0 to 2 percent slopes	18.45	21.6%		Somewhat poorly drained	Illw		85	148	32		60	59	42
24A	Bronson sandy loam, 0 to 3 percent slopes	16.10	18.9%		Moderately well drained	Ils	Ils	100	170	30	55	71	71	52
6B	Oshtemo sandy loam, 0 to 6 percent slopes	14.56	17.1%		Well drained	Ills	Ills					64	64	43
3B	Coloma loamy sand, 0 to 6 percent slopes	14.45	16.9%		Somewhat excessively drained	IVs	Ille					53	53	31
18B	Ormas loamy sand, 0 to 6 percent slopes	10.69	12.5%		Well drained	Ille		80		28		49	49	32

Soils data provided by USDA and NRCS.

Code	Soil Description	Acres	Percent of field	Non-Irr Class Legend	Soil Drainage	Non-Irr Class *c	Irr Class *c	Com Bu	Corn Irrigated Bu	Soybeans Bu	Soybeans Irrigated Bu	*n NCCPI Overall	*n NCCPI Corn	*n NCCPI Soybeans
20B	Spinks loamy sand, 0 to 6 percent slopes	3.77	4.4%		Well drained	lls	lls					55	55	32
6C	Oshtemo sandy loam, 6 to 12 percent slopes	2.74	3.2%		Well drained	lle	lle					63	63	41
33B	Tuscola silt loam, 0 to 4 percent slopes	2.03	2.4%		Moderately well drained	lle		100		32		82	82	80
64B	Urban land-Coloma complex, 0 to 6 percent slopes	1.75	2.1%									41	41	30
26	Gilford sandy loam, 0 to 1 percent slopes	0.74	0.9%		Poorly drained	llw		150		42		77	77	57
Weighted Average						2.89	1.63	51	64.1	17.2	10.4	*n 60.4	*n 60.1	*n 41.3

*n: The aggregation method is "Weighted Average using all components"

*c: Using Capabilities Class Dominant Condition Aggregation Method