

Soils Map

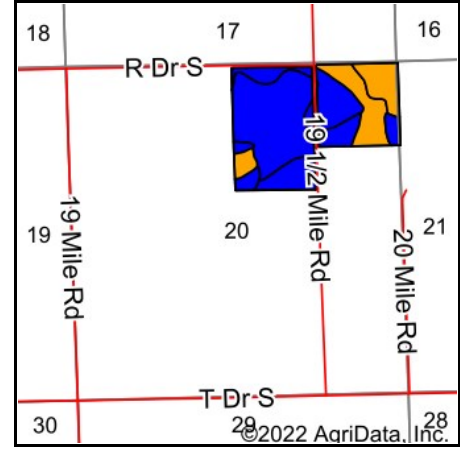

State: **Michigan**
 County: **Calhoun**
 Location: **20-4S-5W**
 Township: **Clarendon**
 Acres: **97.7**
 Date: **8/23/2022**

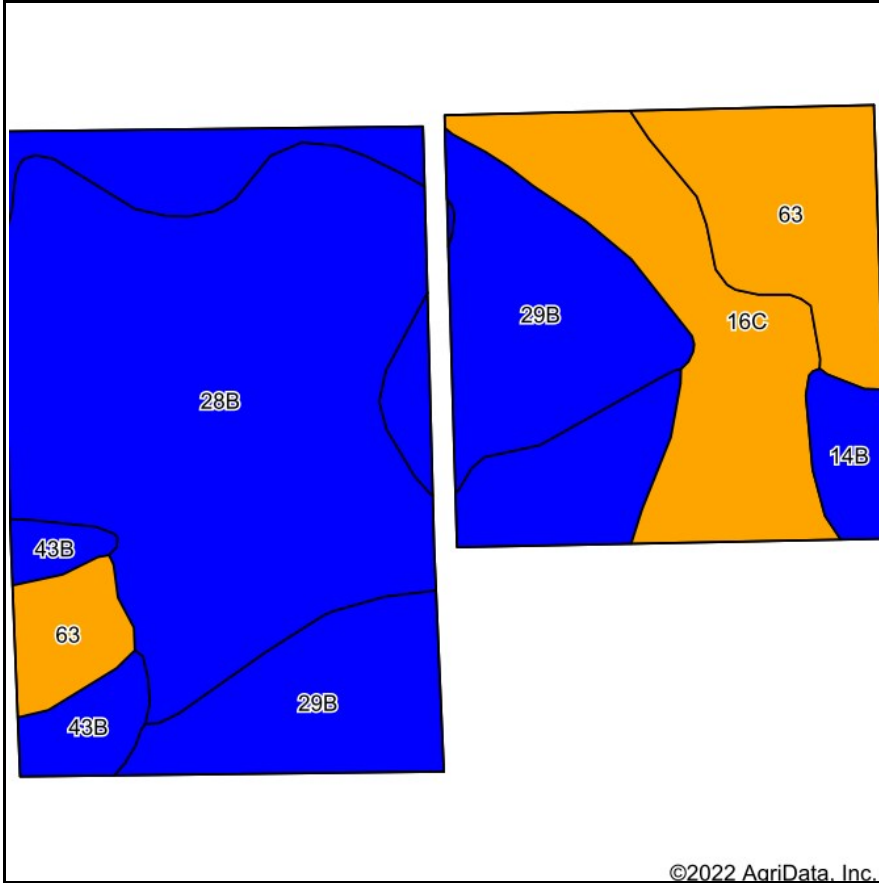

Maps Provided By:



© AgriData, Inc. 2021

www.AgriDataInc.com



Soils data provided by USDA and NRCS.

©2022 AgriData, Inc.

Area Symbol: MI025, Soil Area Version: 19

Code	Soil Description	Acres	Percent of field	Non-Irr Class Legend	Soil Drainage	Non-Irr Class *c	Irr Class *c	Corn Bu	Soybeans Bu	*n NCCPI Overall	*n NCCPI Corn	*n NCCPI Soybeans
28B	Elmdale sandy loam, 2 to 6 percent slopes	42.84	43.8%		Moderately well drained	Ile	Ile			67	67	51
29B	Hillsdale sandy loam, 0 to 6 percent slopes	24.62	25.2%		Well drained	Ile	Ile			67	67	55
16C	Oshtemo sandy loam, 6 to 12 percent slopes	12.93	13.2%		Well drained	IIle	IIle			63	63	41
63	Gilford fine sandy loam, 0 to 2 percent slopes, gravelly subsoil	11.64	11.9%		Poorly drained	IIIw		150	42	51	38	22
43B	Brady sandy loam, 1 to 4 percent slopes	3.29	3.4%		Somewhat poorly drained	Ile				57	56	35
14B	Bronson sandy loam, 0 to 6 percent slopes	2.38	2.4%		Moderately well drained	Ile	Ils			53	53	48
Weighted Average						2.25	*-	17.9	5	*n 63.9	*n 62.3	*n 46.6

*n: The aggregation method is "Weighted Average using all components"

*c: Using Capabilities Class Dominant Condition Aggregation Method

*- Irr Class weighted average cannot be calculated on the current soils data due to missing data.