

Soils Map

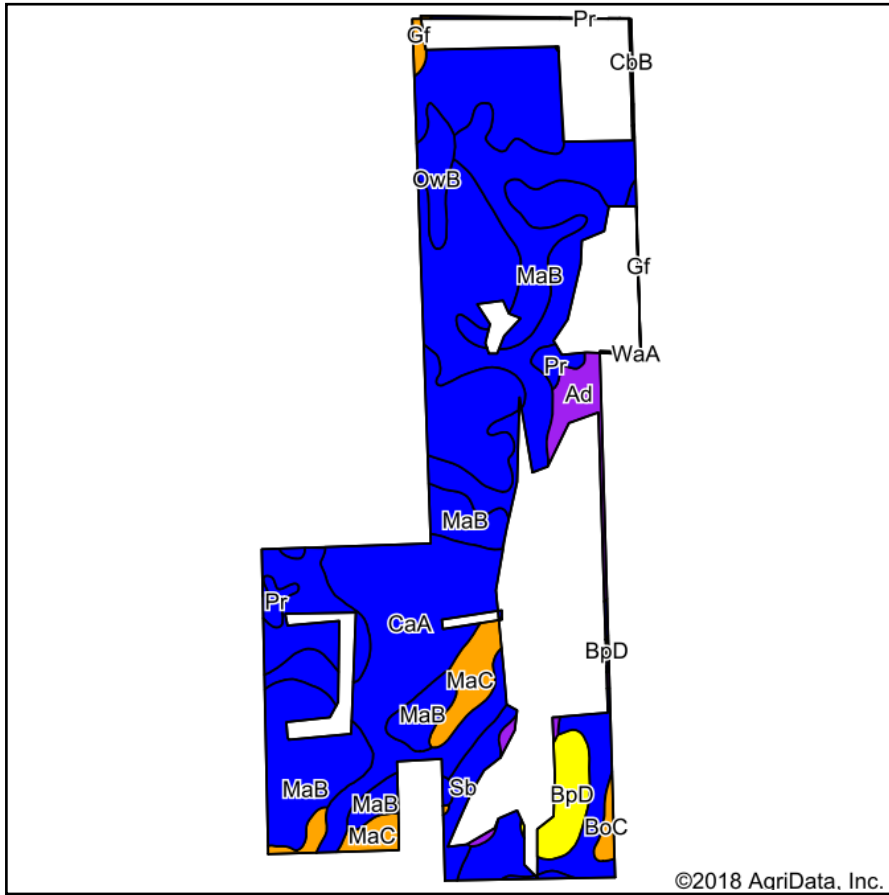

Soils data provided by USDA and NRCS.

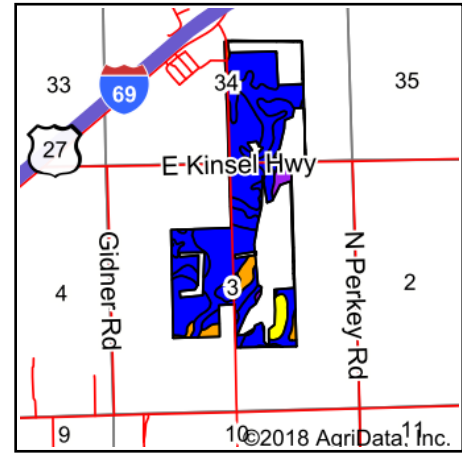

State: **Michigan**
 County: **Eaton**
 Location: **3-2N-4W**
 Township: **Eaton**
 Acres: **202.86**
 Date: **6/29/2018**



Area Symbol: MI045, Soil Area Version: 14

Code	Soil Description	Acres	Percent of field	Non-Irr Class Legend	Non-Irr Class *c	Alfalfa hay	Corn	Corn silage	Oats	Soybeans	Winter wheat	NCCPI Overall
CaA	Capac loam, 0 to 4 percent slopes	90.34	44.5%		Ile							66
MaB	Marlette loam, 2 to 6 percent slopes	65.99	32.5%		Ile							60
MdA	Matherton loam, 0 to 3 percent slopes	10.81	5.3%		IIw	4.5	110	18	90	36	45	60
MaC	Filer loam, 6 to 12 percent slopes	8.88	4.4%		IIIe							58
BpD	Boyer-Spinks loamy sands, 12 to 18 percent slopes	6.13	3.0%		IVe	3.2	65	11	50	21	27	45
Ad	Adrian muck, 0 to 1 percent slopes	5.88	2.9%		Vw							7
Sb	Sebewa loam, 0 to 2 percent slopes	5.07	2.5%		IIw							73
OwB	Owosso-Marlette sandy loams, 1 to 6 percent slopes	4.40	2.2%		Ile	5	115	19	95	35	55	64
Pr	Parkhill loam, non dense till subsoil, 0 to 2 percent slopes	3.02	1.5%		IIw							67
BoC	Boyer sandy loam, 6 to 12 percent slopes	1.25	0.6%		IIIe	3.4	75	12	55	26	32	52
Gf	Gilford sandy loam, 0 to 2 percent slopes, gravelly subsoil	0.82	0.4%		IIIw		149			42	59	71
CbB	Capac-Marlette loams, 1 to 6 percent slopes	0.27	0.1%		Ile							63
Weighted Average						0.5	11.4	1.8	8.7	3.6	4.8	61.1

*c: Using Capabilities Class Dominant Condition Aggregation Method

Soils data provided by USDA and NRCS.