

Soils Map

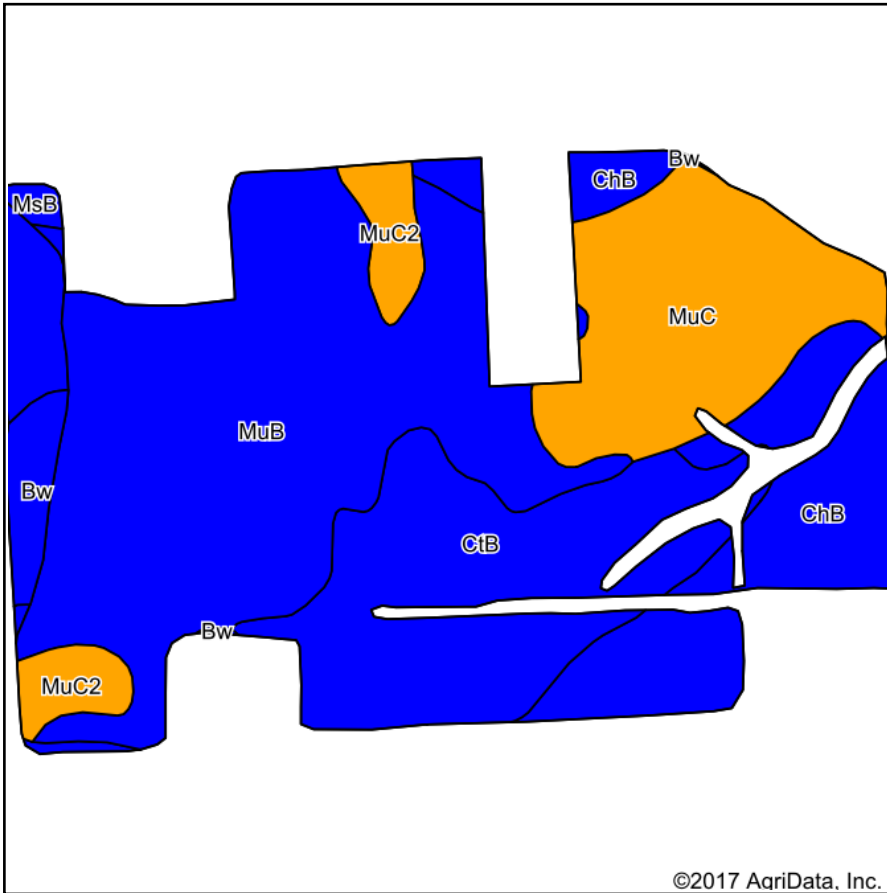

Soils data provided by USDA and NRCS.

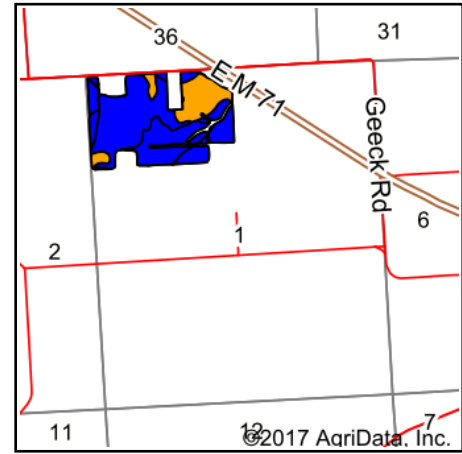

State: **Michigan**
 County: **Shiawassee**
 Location: **1-6N-3E**
 Township: **Shiawassee**
 Acres: **79.2**
 Date: **1/2/2018**



Maps Provided By:



© AgriData, Inc. 2017

www.AgriDataInc.com



Area Symbol: MI155, Soil Area Version: 14

Code	Soil Description	Acres	Percent of field	Non-Irr Class Legend	Water Table	Restrictive Layer	Soil Drainage	Non-Irr Class *c	Corn	Soybeans	Winter wheat
MuB	Miami loam, 2 to 6 percent slopes	31.57	39.9%		> 6.5ft.	> 6.5ft.	Well drained	Ile	131	35	66
CtB	Conover loam, 2 to 6 percent slopes	18.03	22.8%		1ft.	> 6.5ft.	Somewhat poorly drained	Ilw			
MuC	Miami loam, 6 to 12 percent slopes	12.43	15.7%		> 6.5ft.	> 6.5ft.	Well drained	Ille	131	35	66
ChB	Celina loam, 2 to 6 percent slopes	11.86	15.0%		2ft.	> 6.5ft.	Moderately well drained	Ile	132	35	66
MuC2	Miami loam, 6 to 12 percent slopes, moderately eroded	3.16	4.0%		> 6.5ft.	> 6.5ft.	Well drained	Ille	125	33	63
Bw	Brookston loam, 0 to 2 percent slopes	1.75	2.2%		0ft.	> 6.5ft.	Poorly drained	Ilw			
MsB	Metamora sandy loam, 2 to 6 percent slopes	0.40	0.5%		0.5ft.	> 6.5ft.	Somewhat poorly drained	Ile	136	40	66
Weighted Average									98.2	26.2	49.4

*c: Using Capabilities Class Dominant Condition Aggregation Method

Soils data provided by USDA and NRCS.