

Soils Map

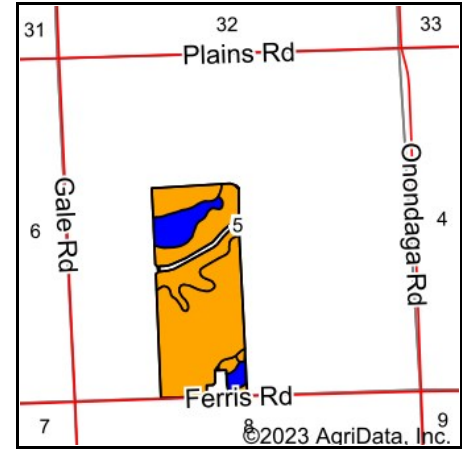

State: **Michigan**
 County: **Ingham**
 Location: **5-1N-2W**
 Township: **Onondaga**
 Acres: **95.25**
 Date: **1/17/2023**

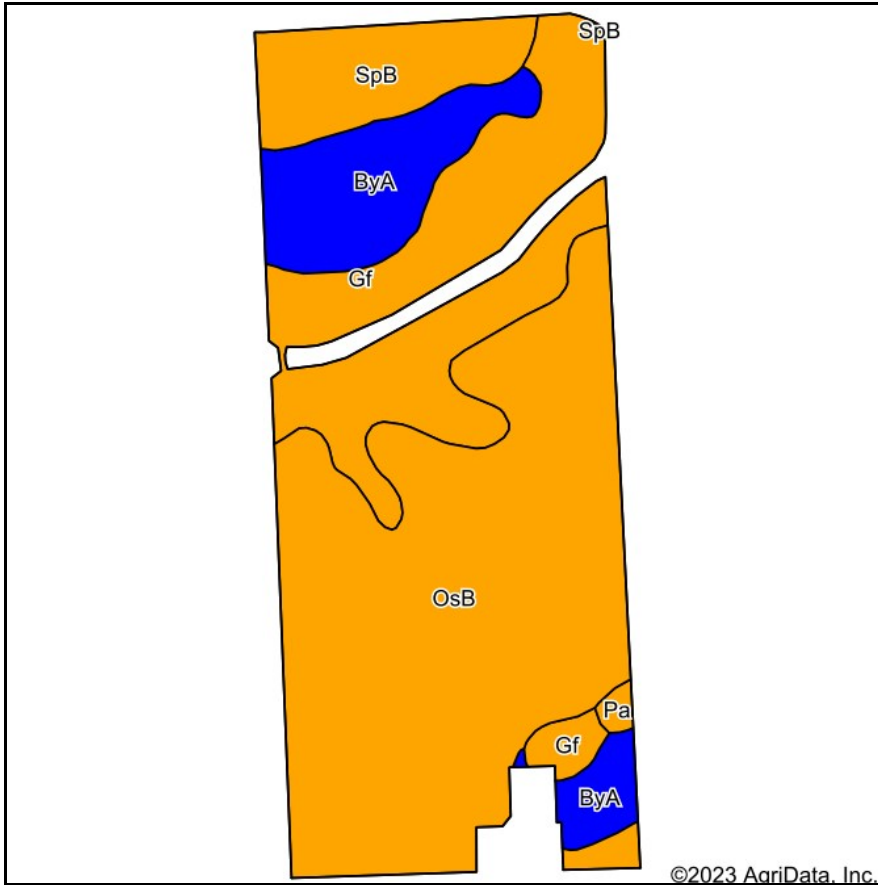

Soils data provided by USDA and NRCS.

©2023 AgriData, Inc.

Archived Soils Ending 11/6/2014 Area Symbol: MI065, Soil Area Version: 11

Code	Soil Description	Acres	Percent of field	Non-Irr Class Legend	Non-Irr Class *c	Irr Class *c	Alfalfa hay Tons	Alfalfa hay Irrigated Tons	Bromegrass alfalfa hay Tons	Bromegrass alfalfa hay Irrigated Tons	Canarygrass hay Tons	Corn Bu	Corn Irrigated Bu	Corn silage Tons	Corn silage Irrigated Tons	Gr leg hay Tons
OsB	Oshtemo sandy loam, 0 to 6 percent slopes	51.01	53.6%		Ills	Ille	3.5	8	2.5	8		95	175	10	27	
Gf	Gilford sandy loam	23.69	24.9%		Illw							90		1.5		
ByA	Brady sandy loam, 0 to 3 percent slopes	11.72	12.3%		Ilw		4.5		3.2			115		19		
SpB	Spinks loamy sand, 0 to 6 percent slopes	8.36	8.8%		Ills	Ills				3	7	75	165	13	24	
Pa	Palms muck	0.47	0.5%		Illw							3	118	18		
Weighted Average					2.88	*-	2.4	4.3	2	4.9	*-	94.6	108.2	9.3	16.6	

*c: Using Capabilities Class Dominant Condition Aggregation Method

*- Irr Class weighted average cannot be calculated on the current soils data due to missing data.

Soils Map

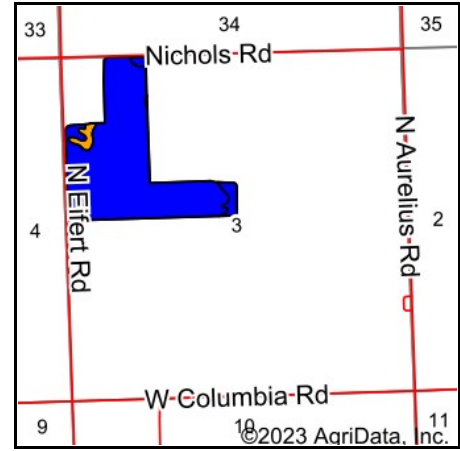
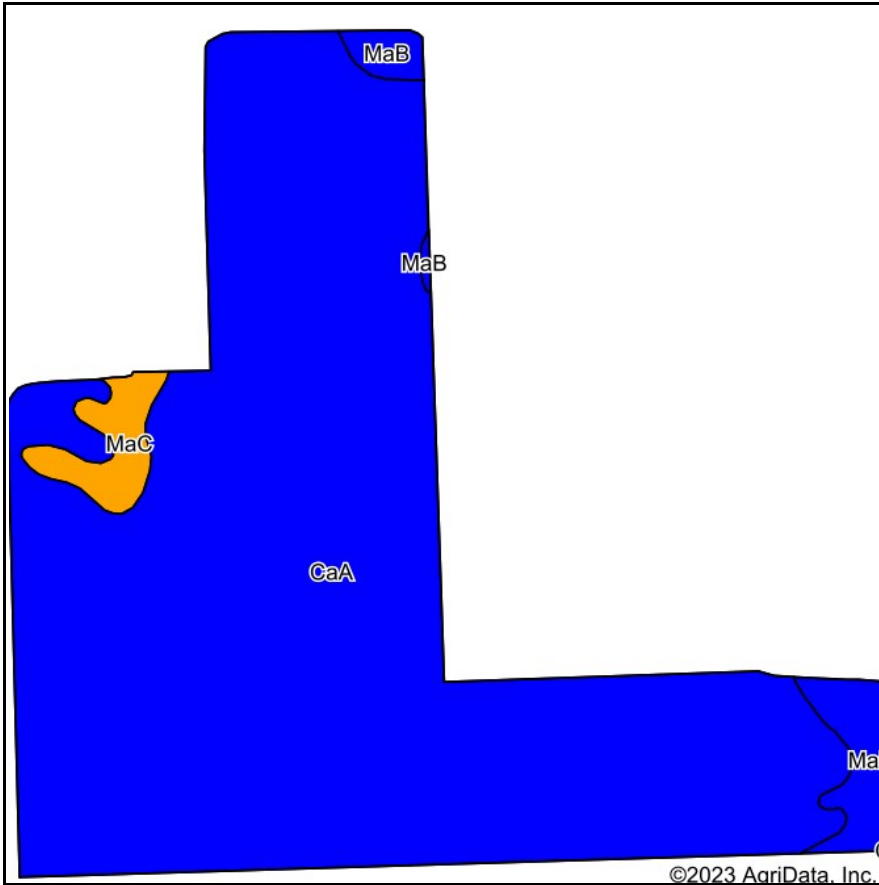

State: **Michigan**
 County: **Ingham**
 Location: **3-2N-2W**
 Township: **Aurelius**
 Acres: **76.12**
 Date: **1/17/2023**



Soils data provided by USDA and NRCS.

Archived Soils Ending 11/15/2015 Area Symbol: MI065, Soil Area Version: 12

Code	Soil Description	Acres	Percent of field	Non-Irr Class Legend	Non-Irr Class *c	Alfalfa hay Tons	Alfalfa hay Irrigated Tons	Bromegrass alfalfa hay Tons	Bromegrass alfalfa hay Irrigated Tons	Corn Bu	Corn Irrigated Bu	Corn silage Tons	Corn silage Irrigated Tons	Dry beans Bu	Dry beans Irrigated Bu	Oats Bu	S
CaA	Capac loam, 0 to 3 percent slopes	71.13	93.4%		llw	5.5	7			120	155	18	26			100	
MaB	Marlette fine sandy loam, 2 to 6 percent slopes	3.07	4.0%		lle	4.8		3.5		120	160	19	27	35	60	95	
MaC	Marlette fine sandy loam, 6 to 12 percent slopes	1.92	2.5%		lle	4.5		3.2	7.5	110	150	15	25	30		90	
Weighted Average						2.03	5.4	6.5	0.2	0.2	119.7	155.1	18	26	2.2	2.4	99.5

*c: Using Capabilities Class Dominant Condition Aggregation Method

Soils Map

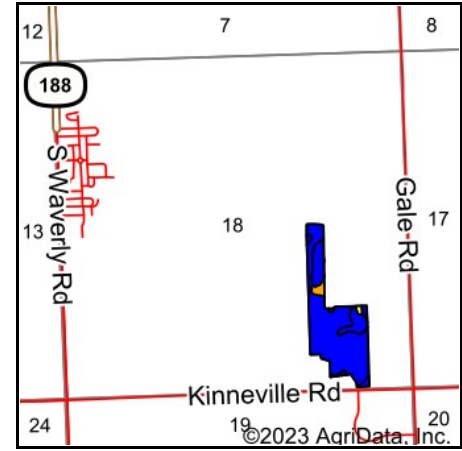
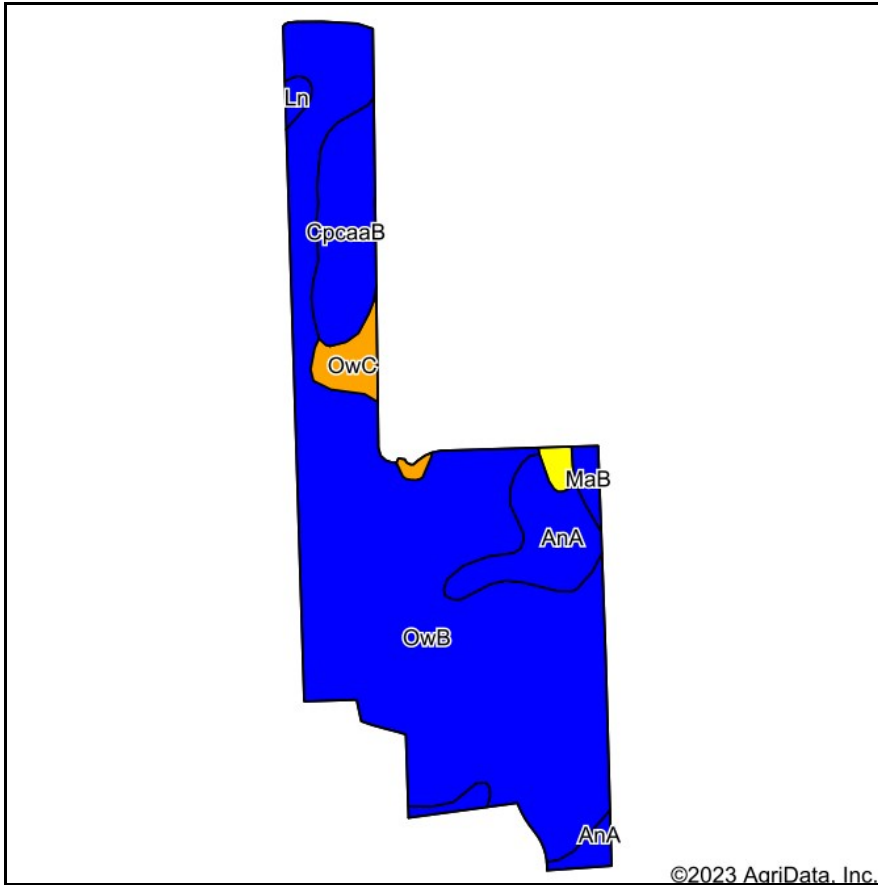

State: **Michigan**
 County: **Ingham**
 Location: **18-1N-2W**
 Township: **Onondaga**
 Acres: **29.37**
 Date: **1/17/2023**



Area Symbol: MI065, Soil Area Version: 20

Code	Soil Description	Acres	Percent of field	Non-Irr Class Legend	Non-Irr Class *c	Alfalfa hay Tons	Bromegrass alfalfa hay Tons	Corn Bu	Corn silage Tons	Corn silage Irrigated Tons	Grass legume hay Tons	Oats Bu	Soybeans Bu	Tall fescue AUM	Winter wheat Bu	*n NC Soyb
OwB	Owosso-Marlette sandy loams, 2 to 6 percent slopes	22.30	75.9%		Ile	5	3.5	115	19			95	35		55	
AnA	Aubbeenaubbee-Capac sandy loams, 0 to 3 percent slopes	2.77	9.4%		Ilw			110			3.6		38	7.2	50	
CpcaaB	Capac loam, 0 to 4 percent slopes	2.63	9.0%		Ile											
OwC	Owosso-Marlette sandy loams, 6 to 12 percent slopes	0.88	3.0%		Ile	5	3	100	17			90	33		50	
MaB	Marlette fine sandy loam, 2 to 6 percent slopes	0.33	1.1%		Ile											
MeD2	Marlette loam, 12 to 18 percent slopes, eroded	0.26	0.9%		Ive	3.8	2.7	85	13	20		65			48	
Ln	Lenawee silty clay loam	0.20	0.7%		Ilw	6	4.2	130	20			100	42		60	
Weighted Average					2.05	4	2.8	102.3	15.2	0.2	0.3	76.1	31.4	0.7	48.8	

*n: The aggregation method is "Weighted Average using all components"

*c: Using Capabilities Class Dominant Condition Aggregation Method