

Soils Map

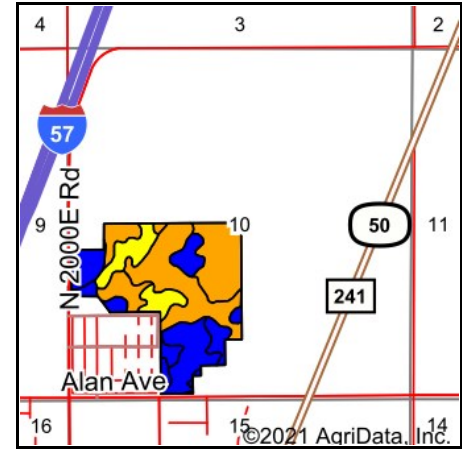

State: **Illinois**
 County: **Kankakee**
 Location: **10-32N-12E**
 Township: **Manteno**
 Acres: **99.88**
 Date: **8/5/2021**

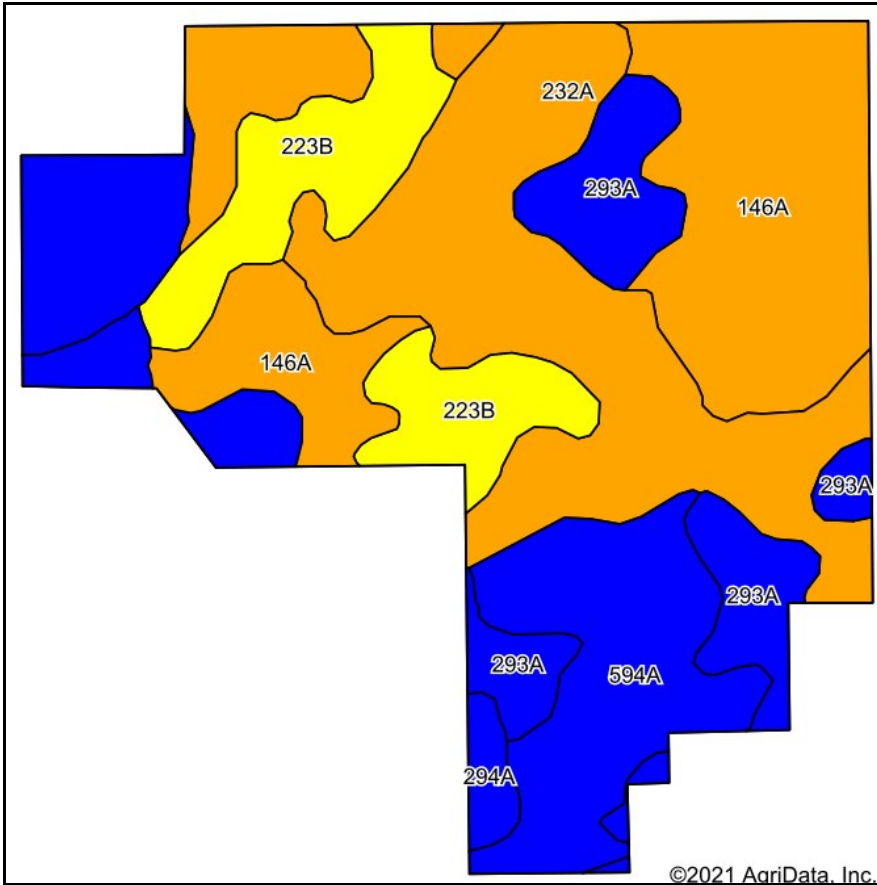

Maps Provided By:



Soils data provided by USDA and NRCS.

Area Symbol: IL091, Soil Area Version: 17

Code	Soil Description	Acres	Percent of field	Il. State Productivity Index Legend	Water Table	Subsoil rooting ^a	Corn Bu/A	Soybeans Bu/A	Wheat Bu/A	Oats Bu/A ^b	Sorghum ^c Bu/A	Alfalfa ^d hay, T/A	Grass-legume ^e hay, T/A	Crop productivity index for optimum management
146A	Elliott silt loam, 0 to 2 percent slopes	27.86	27.9%		1.5ft.	FAV	168	55	68	87	0	0.00	5.02	125
232A	Ashkum silty clay loam, 0 to 2 percent slopes	25.41	25.4%		0.5ft.	FAV	170	56	65	85	0	0.00	5.14	127
594A	Reddick clay loam, 0 to 2 percent slopes	18.91	18.9%		0.5ft.	FAV	177	56	66	89	0	0.00	5.14	130
293A	Andres silt loam, 0 to 2 percent slopes	14.12	14.1%		1.6ft.	FAV	184	59	71	97	0	0.00	5.39	135
**223B	Varna silt loam, 2 to 4 percent slopes	12.25	12.3%		2.7ft.	FAV	**156	**50	**63	**78	0	**4.84	0.00	**115
294A	Symerton silt loam, 0 to 2 percent slopes	1.33	1.3%		3.4ft.	FAV	179	56	69	92	0	6.27	0.00	131



Code	Soil Description	Acres	Percent of field	Il. State Productivity Index Legend	Water Table	Subsoil rooting a	Corn Bu/A	Soybeans Bu/A	Wheat Bu/A	Oats Bu/A b	Sorghum c Bu/A	Alfalfa d hay, T/A	Grass-legume e hay, T/A	Crop productivity index for optimum management
Weighted Average							171.1	55.4	66.7	87.2	*-	0.68	4.44	126.7

Table: Optimum Crop Productivity Ratings for Illinois Soil by K.R. Olson and J.M. Lang, Office of Research, ACES, University of Illinois at Champaign-Urbana. Version: 1/2/2012 Amended Table S2 B811

Crop yields and productivity indices for optimum management (B811) are maintained at the following NRES web site:

<http://soilproductivity.nres.illinois.edu/>

** Indexes adjusted for slope and erosion according to Bulletin 811 Table S3

a UNF = unfavorable; FAV = favorable

b Soils in the southern region were not rated for oats and are shown with a zero "0".

c Soils in the northern region or in both regions were not rated for grain sorghum and are shown with a zero "0".

d Soils in the poorly drained group were not rated for alfalfa and are shown with a zero "0".

e Soils in the well drained group were not rated for grass-legume and are shown with a zero "0".