

Soils Map

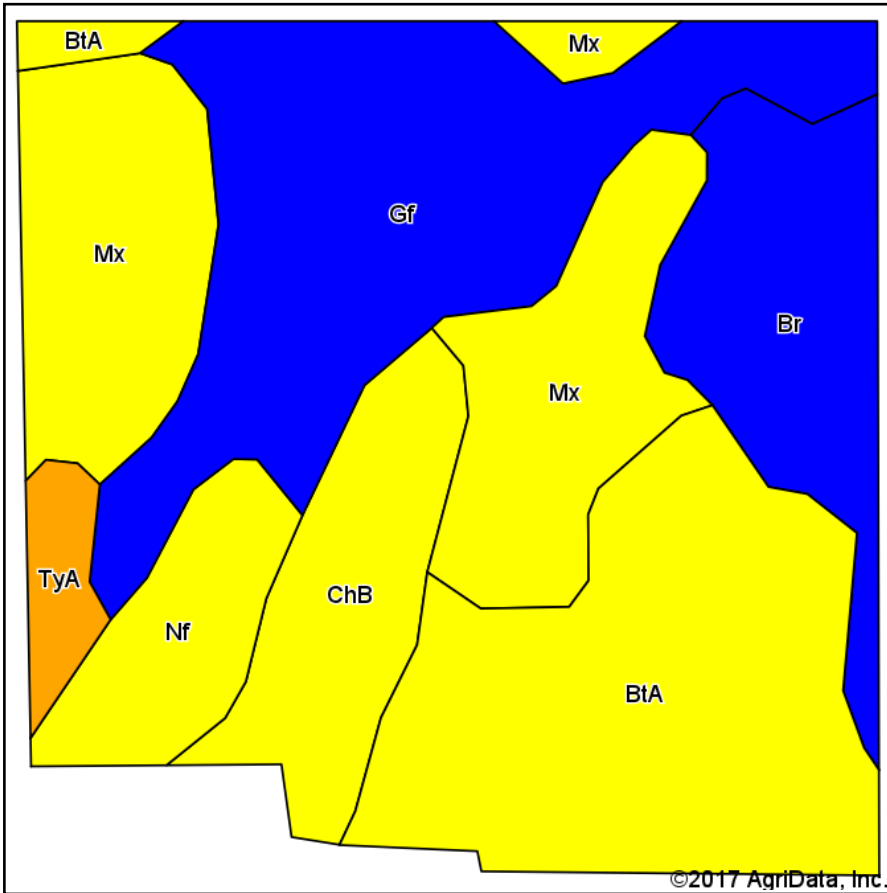

Soils data provided by USDA and NRCS.

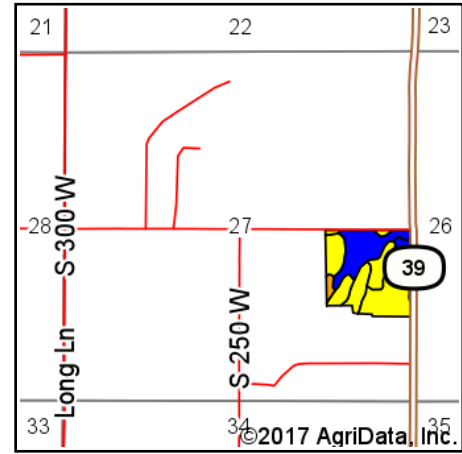

State: **Indiana**
 County: **La Porte**
 Location: **27-34N-3W**
 Township: **Prairie**
 Acres: **37.85**
 Date: **2/12/2017**



Maps Provided By:



© AgriData, Inc. 2017

www.AgriDataInc.com



Area Symbol: IN091, Soil Area Version: 21

Code	Soil Description	Acres	Percent of field	Non-Irr Class Legend	Water Table	Soil Drainage	Non-Irr Class *c	Corn	Corn Irrigated	Soybeans	Soybeans Irrigated	Winter wheat
Gf	Gilford fine sandy loam, 0 to 1 percent slopes	9.55	25.2%		0.2ft.	Poorly drained	IIw	148		42		60
BtA	Brems fine sand, 0 to 3 percent slopes	9.29	24.5%		2.2ft.	Moderately well drained	IVs	90		32		41
Mx	Morocco loamy fine sand	8.03	21.2%		3ft.	Somewhat poorly drained	IVs	102		28		46
Br	Bourbon sandy loam	4.33	11.4%		1.2ft.	Somewhat poorly drained	IIw	108		31		49
ChB	Chelsea fine sand, 2 to 6 percent slopes	3.49	9.2%		> 6.5ft.	Excessively drained	IVs	85		30		38
Nf	Newton loamy fine sand	2.32	6.1%		0.2ft.	Very poorly drained	IVw	115		25		46
TyA	Tyner loamy sand, 0 to 2 percent slopes	0.84	2.2%		> 6.5ft.	Excessively drained	IIIs	77	8	27	3	35
Weighted Average								110	0.2	32.8	0.1	47.7

Area Symbol: IN091, Soil Area Version: 21

*c: Using Capabilities Class Dominant Condition Aggregation Method

Soils data provided by USDA and NRCS.