

# Soils Map

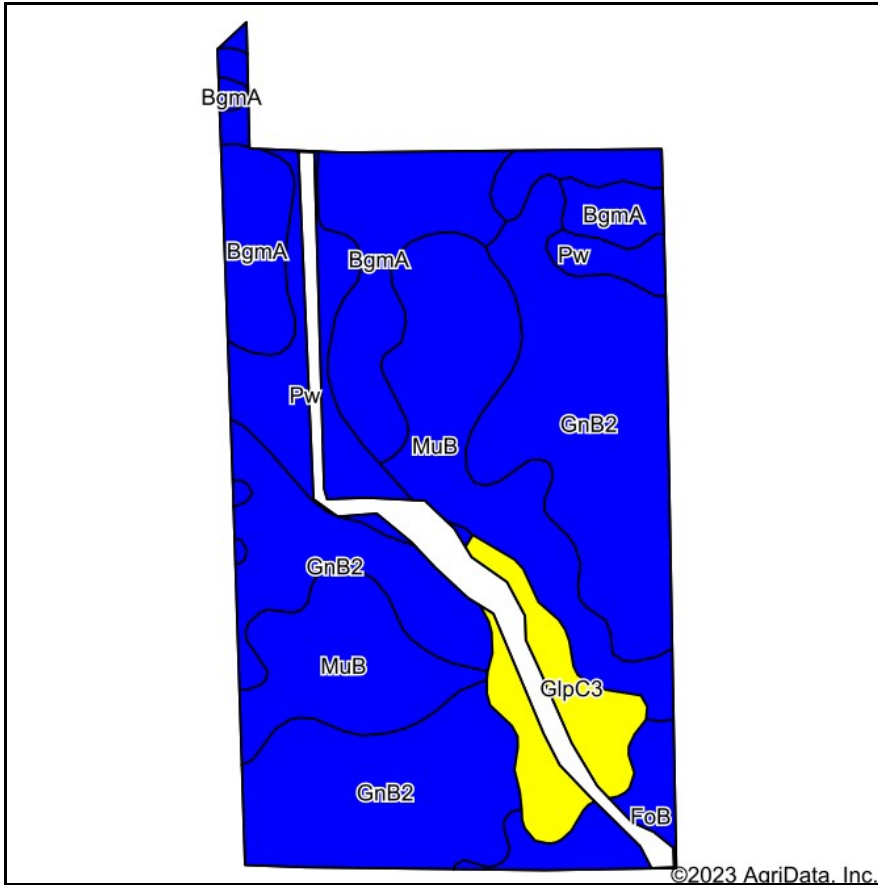

Soils data provided by USDA and NRCS.

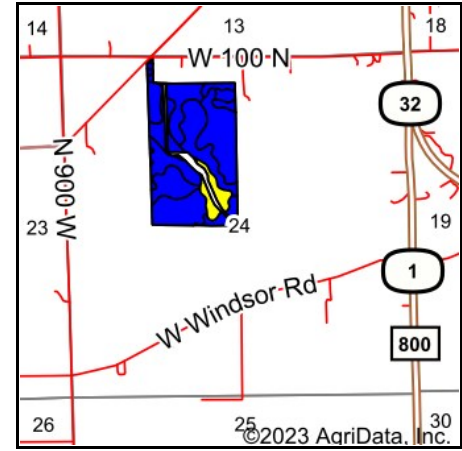

State: **Indiana**  
 County: **Randolph**  
 Location: **24-20N-12E**  
 Township: **Stoney Creek**  
 Acres: **64.24**  
 Date: **1/20/2023**



Maps Provided By:



Area Symbol: IN135, Soil Area Version: 26

Code	Soil Description	Acres	Percent of field	Non-Irr Class Legend	Water Table	Non-Irr Class *c	Corn Bu	Soybeans Bu	Winter wheat Bu	*n NCCPI Corn	*n NCCPI Soybeans
GnB2	Glynwood silt loam, 1 to 4 percent slopes, eroded	25.58	39.8%		1.5ft.	Ile	129	44	57	61	40
MuB	Morley silt loam, 3 to 6 percent slopes	14.46	22.5%		2.7ft.	Ile	117	41	53	62	47
BgmA	Blount silt loam, ground moraine, 0 to 2 percent slopes	10.06	15.7%		0.7ft.	Ilw	141	45	63	70	58
Pw	Pewamo silty clay loam, 0 to 1 percent slopes	7.40	11.5%		0.5ft.	Ilw	157	47	64	75	66
GlpC3	Glynwood clay loam, 6 to 12 percent slopes, severely eroded	4.27	6.6%		1.5ft.	Ive	112	29	49	52	28
FoB	Fox loam, 2 to 6 percent slopes	2.47	3.8%		> 6.5ft.	Ile	101	34	45	70	64
<b>Weighted Average</b>						<b>2.13</b>	<b>129.2</b>	<b>42.4</b>	<b>56.9</b>	<b>*n 64</b>	<b>*n 47.5</b>

\*n: The aggregation method is "Weighted Average using all components"

\*c: Using Capabilities Class Dominant Condition Aggregation Method

Soils data provided by USDA and NRCS.