

Soils Map

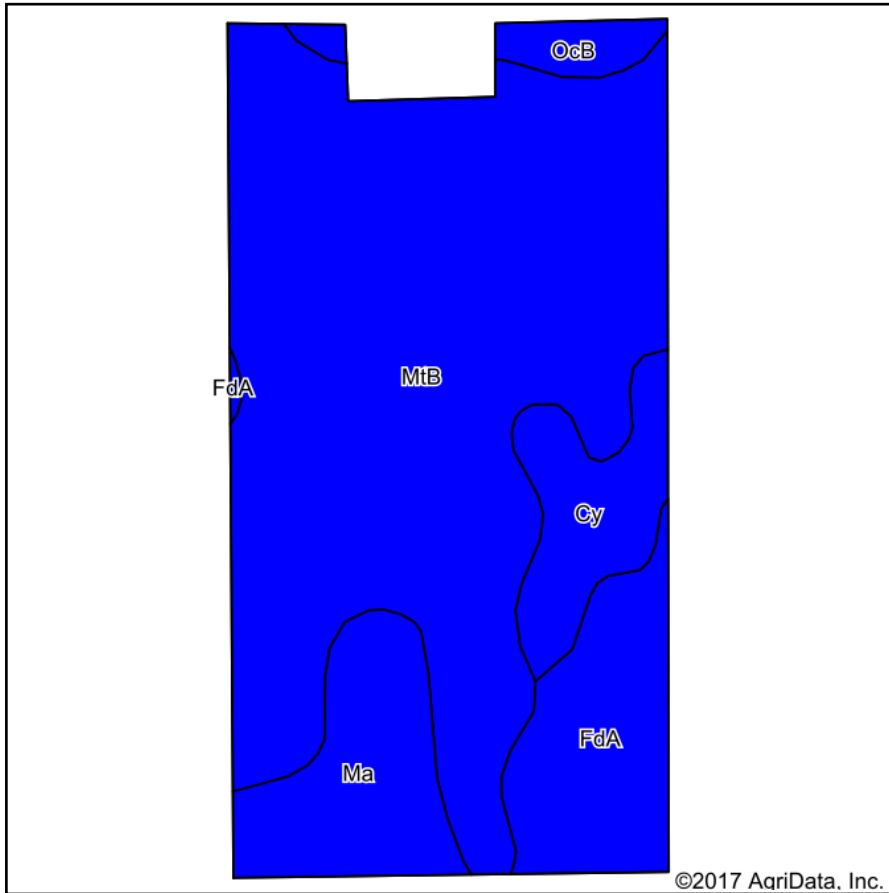

Soils data provided by USDA and NRCS.

©2017 AgriData, Inc.

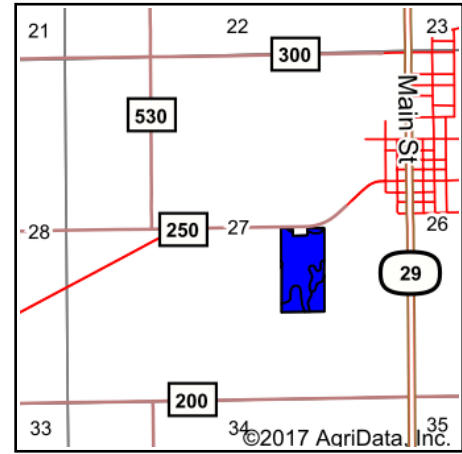

State: **Indiana**
 County: **Clinton**
 Location: **27-22N-1E**
 Township: **Michigan**
 Acres: **19.05**
 Date: **10/24/2017**



Maps Provided By:



© AgriData, Inc. 2017

www.AgrIDataInc.com



Area Symbol: IN023, Soil Area Version: 20

Code	Soil Description	Acres	Percent of field	Non-Irr Class Legend	Water Table	Soil Drainage	Non-Irr Class *c	Corn	Soybeans	Winter wheat
MtB	Miami-Crosby silt loams, 2 to 6 percent slopes	12.93	67.9%		0.5ft.	Moderately well drained	Ile	147	50	65
FdA	Fincastle-Crosby silt loams, 0 to 2 percent slopes	2.16	11.3%		0.5ft.	Somewhat poorly drained	Ilw	156	51	69
Ma	Mahalasville silty clay loam, 0 to 2 percent slopes	2.01	10.6%		0.2ft.	Poorly drained	Ilw	181	52	71
Cy	Cyclone silt loam, 0 to 2 percent slopes	1.45	7.6%		0.2ft.	Poorly drained	Ilw	185	56	75
OcB	Ockley silt loam, 2 to 6 percent slopes	0.50	2.6%		> 6.5ft.	Well drained	Ile	132	46	66
Weighted Average								154.1	50.7	66.9

*c: Using Capabilities Class Dominant Condition Aggregation Method

Soils data provided by USDA and NRCS.

Soils Map

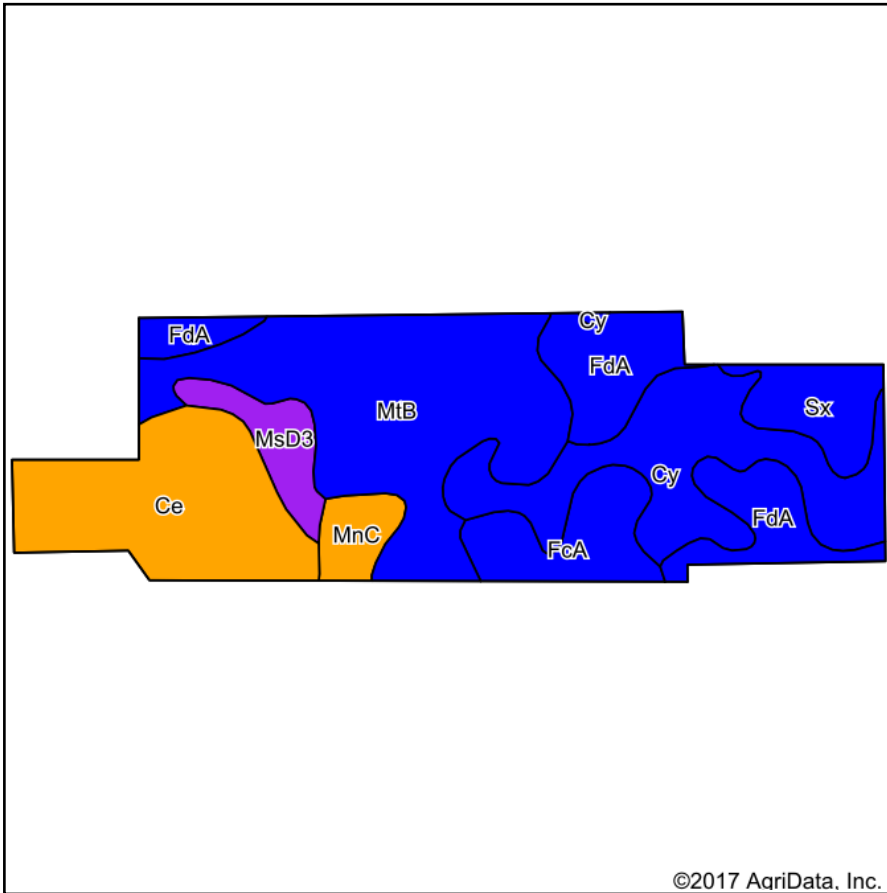

Soils data provided by USDA and NRCS.

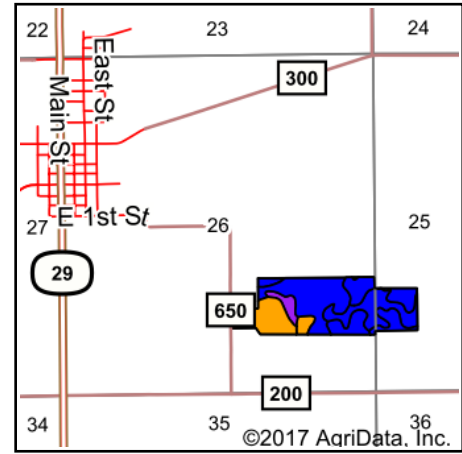

State: **Indiana**
 County: **Clinton**
 Location: **26-22N-1E**
 Township: **Michigan**
 Acres: **51.14**
 Date: **10/24/2017**



Maps Provided By:



© AgriData, Inc. 2017

www.AgriDataInc.com



Area Symbol: IN023, Soil Area Version: 20

Code	Soil Description	Acres	Percent of field	Non-Irr Class Legend	Water Table	Soil Drainage	Non-Irr Class *c	Corn	Soybeans	Winter wheat
MtB	Miami-Crosby silt loams, 2 to 6 percent slopes	14.90	29.1%		0.5ft.	Moderately well drained	Ile	147	50	65
Cy	Cyclone silt loam, 0 to 2 percent slopes	9.43	18.4%		0.2ft.	Poorly drained	Ilw	185	56	75
Ce	Ceresco loam	9.32	18.2%		1.2ft.	Somewhat poorly drained	Illw	112	30	51
FdA	Fincastle-Crosby silt loams, 0 to 2 percent slopes	7.20	14.1%		0.5ft.	Somewhat poorly drained	Ilw	156	51	69
FcA	Fincastle silt loam, Tipton Till Plain, 0 to 2 percent slopes	3.70	7.2%		0.5ft.	Somewhat poorly drained	Ilw	168	54	74
Sx	Starks silt loam	2.84	5.6%		1.2ft.	Somewhat poorly drained	Ilw	141	46	64
MsD3	Miami clay loam, 12 to 18 percent slopes, severely eroded	2.21	4.3%		> 6.5ft.	Well drained	Vle	110	39	55
MnC	Miami silt loam, 6 to 12 percent slopes	1.54	3.0%		2.7ft.	Moderately well drained	Ille	135	47	61
Weighted Average								148.1	47.1	64.9

*c: Using Capabilities Class Dominant Condition Aggregation Method

Soils data provided by USDA and NRCS.

Soils Map

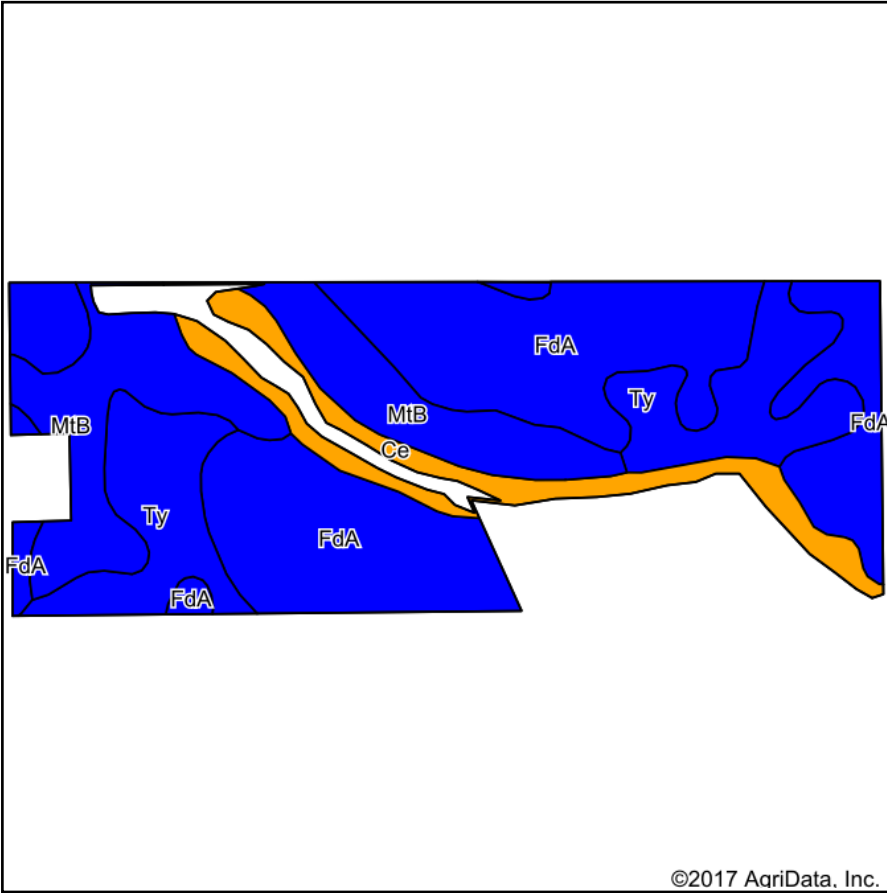

Soils data provided by USDA and NRCS.

©2017 AgriData, Inc.

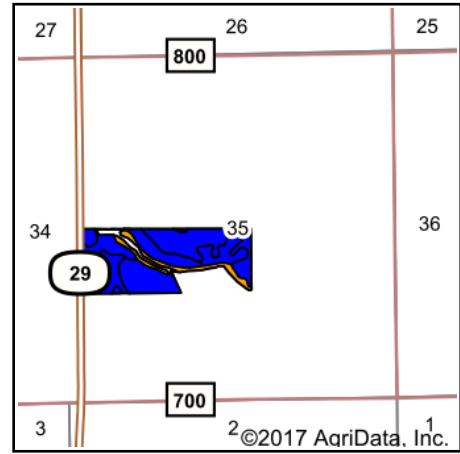

State: **Indiana**
 County: **Clinton**
 Location: **35-23N-1E**
 Township: **Warren**
 Acres: **48.28**
 Date: **10/24/2017**



Maps Provided By:



© AgriData, Inc. 2017

www.AgriDataInc.com



Area Symbol: IN023, Soil Area Version: 20

Cod e	Soil Description	Acres	Percent of field	Non-Irr Class Legend	Water Table	Soil Drainage	Non-Irr Class *c	Corn	Soybeans	Winter wheat
FdA	Fincastle-Crosby silt loams, 0 to 2 percent slopes	22.21	46.0%		0.5ft.	Somewhat poorly drained	IIw	156	51	69
Ty	Treaty silt loam, 0 to 2 percent slopes	10.73	22.2%		0ft.	Poorly drained	IIw	175	52	71
MtB	Miami-Crosby silt loams, 2 to 6 percent slopes	10.58	21.9%		0.5ft.	Moderately well drained	Ile	147	50	65
Ce	Ceresco loam	4.76	9.9%		1.2ft.	Somewhat poorly drained	IIIw	112	30	51
Weighted Average								153.9	48.9	66.8

*c: Using Capabilities Class Dominant Condition Aggregation Method

Soils data provided by USDA and NRCS.