

# Soils Map

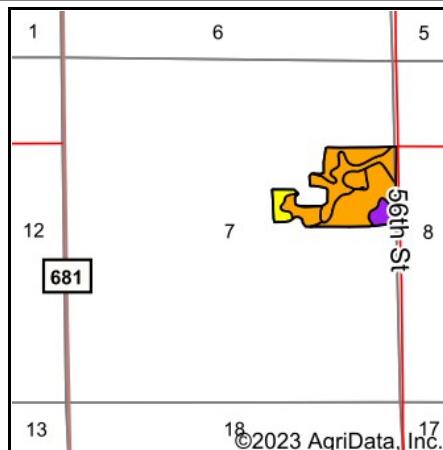

State: **Michigan**  
 County: **Van Buren**  
 Location: **7-4S-15W**  
 Township: **Hamilton**  
 Acres: **37.27**  
 Date: **4/4/2023**

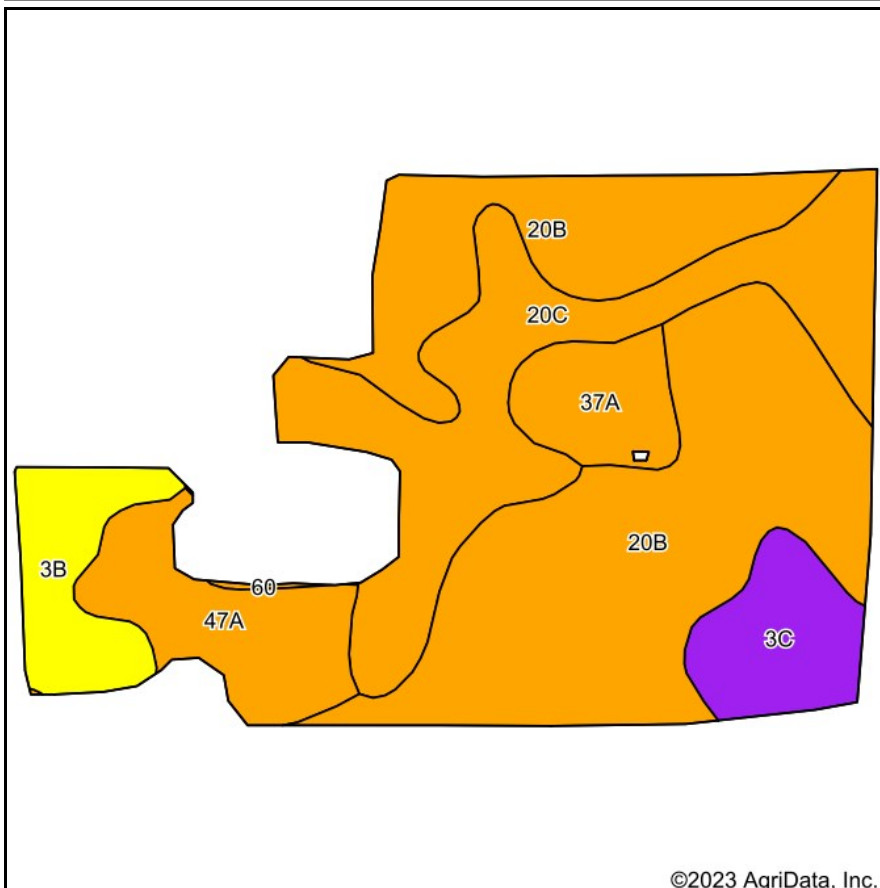

Maps Provided By:



© AgriData, Inc. 2023

www.AgriDataInc.com



Soils data provided by USDA and NRCS.

## Archived Soils Ending 1/21/2012

Code	Soil Description	Acres	Percent of field	Non-Irr Class Legend	Water Table	Restrictive Layer	Soil Drainage	Non-Irr Class *c	Irr Class *c	Corn Bu	Corn Irrigated Bu	Soybeans Bu	Soybeans Irrigated Bu	Winter wheat Bu
20B	Spinks loamy sand, 0 to 6 percent slopes	17.75	47.6%		0ft.	> 6.5ft.	Well drained	Ills	Ills	75	165	27	50	30
20C	Spinks loamy sand, 6 to 12 percent slopes	8.71	23.4%		0ft.	> 6.5ft.	Well drained	Ille	Ille	68	155	23	50	30
47A	Selfridge loamy sand, 0 to 3 percent slopes	3.51	9.4%		0.5ft.	> 6.5ft.	Somewhat poorly drained	Illw		110		35		42
3C	Coloma loamy sand, 6 to 12 percent slopes	2.62	7.0%		> 6.5ft.	> 6.5ft.	Excessively drained	VIs						
3B	Coloma loamy sand, 0 to 6 percent slopes	2.57	6.9%		> 6.5ft.	> 6.5ft.	Excessively drained	IVs	Ille	45	170	18	55	

Soils data provided by USDA and NRCS.



Code	Soil Description	Acres	Percent of field	Non-Irr Class Legend	Water Table	Restrictive Layer	Soil Drainage	Non-Irr Class *c	Irr Class *c	Corn Bu	Corn Irrigated Bu	Soybeans Bu	Soybeans Irrigated Bu	Winter wheat Bu
37A	Thetford loamy sand, 0 to 2 percent slopes	2.04	5.5%		0.5ft.	> 6.5ft.	Somewhat poorly drained	Illw		85	148	32		35
60	Belleville loamy sand	0.07	0.2%		0ft.	> 6.5ft.	Poorly drained	Illw		115		35		50
<b>Weighted Average</b>								<b>3.28</b>	<b>*-</b>	<b>69.9</b>	<b>134.6</b>	<b>24.6</b>	<b>39.3</b>	<b>27.3</b>

\*c: Using Capabilities Class Dominant Condition Aggregation Method

\*- Irr Class weighted average cannot be calculated on the current soils data due to missing data.