

Soils Map

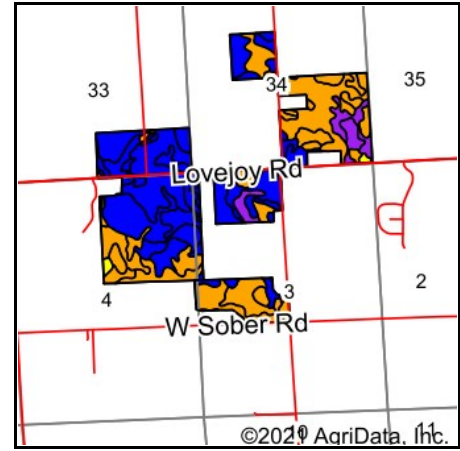

State: **Michigan**
 County: **Livingston**
 Location: **3-4N-3E**
 Township: **Conway**
 Acres: **591.35**
 Date: **12/15/2021**

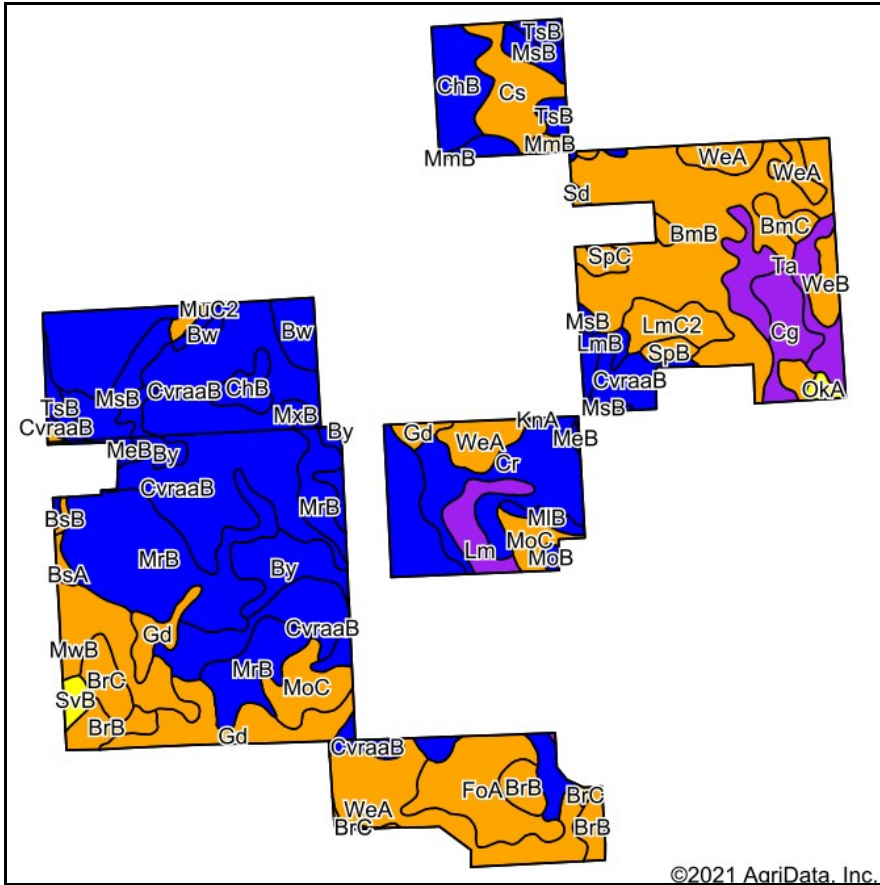

Maps Provided By:



Soils data provided by USDA and NRCS.

©2021 AgriData, Inc.

© AgriData, Inc. 2021

www.AgrDataInc.com

Area Symbol: MI093, Soil Area Version: 19
 Area Symbol: MI155, Soil Area Version: 19

Code	Soil Description	Acres	Percent of field	Non-Irr Class Legend	Water Table	Non-Irr Class *c	Irr Class *c	Corn Bu	Soybeans Bu	Soybeans Tons	Winter wheat Bu	*n NCCPI Overall	*n NCCPI Corn	*n NCCPI Soybeans
CvraaB	Conover loam, 0 to 4 percent slopes	73.93	12.5%		1ft.	llw						45	44	36
BmB	Boyer loamy sand, 2 to 6 percent slopes	63.41	10.7%		> 6.5ft.	llle		88	30		38	49	48	25
MrB	Miami-Conover loams, 2 to 6 percent slopes	61.60	10.4%		1.5ft.	lle		120	35		60	80	79	76
CvraaB	Conover loam, 0 to 4 percent slopes	58.39	9.9%		1ft.	llw						45	44	36
WeA	Wasepi sandy loam, 0 to 2 percent slopes	32.29	5.5%		1.5ft.	lllw		115	33		50	60	60	38
Cr	Colwood fine sandy loam	32.21	5.4%		0ft.	llw		140	45		65	85	56	85
Gd	Gilford sandy loam, 0 to 2 percent slopes, gravelly subsoil	24.26	4.1%		3.5ft.	lllw		149	42		59	49	37	21
FoA	Fox sandy loam, 0 to 2 percent slopes	21.18	3.6%		> 6.5ft.	llls		105	35		42	63	63	42

Soils data provided by USDA and NRCS.

Code	Soil Description	Acres	Percent of field	Non-Irr Class Legend	Water Table	Non-Irr Class *c	Irr Class *c	Corn Bu	Soybeans Bu	Soybeans Tons	Winter wheat Bu	*n NCCPI Overall	*n NCCPI Corn	*n NCCPI Soybeans
MsB	Metamora sandy loam, 2 to 6 percent slopes	17.82	3.0%		1.5ft.	Ile		136	40		66	75	75	68
ChB	Celina loam, 2 to 6 percent slopes	17.73	3.0%		1.5ft.	Ile		132	35		66	81	81	81
MwB	Minoa-Thetford complex, 0 to 4 percent slopes	16.24	2.7%		1.5ft.	IIIw		100		32.5	42.5	62	62	45
Ta	Timakwa muck	16.21	2.7%		0ft.	V w						18	9	6
MoC	Wawasee loam, 6 to 12 percent slopes	15.24	2.6%		> 6.5ft.	Ile						58	58	54
Cs	Colwood loam	14.13	2.4%		0ft.	IIIw		154	45		71	51	32	24
By	Brookston loam, 0 to 2 percent slopes	13.73	2.3%		0ft.	IIw						76	73	75
BrB	Boyer loamy sand, 2 to 6 percent slopes	13.56	2.3%		> 6.5ft.	III s		80	30		35	58	58	31
WeA	Wasepi sandy loam, 0 to 2 percent slopes	10.43	1.8%		1.5ft.	IIIw		126	35		60	58	57	33
Cg	Carlisle muck, 0 to 2 percent slopes	10.23	1.7%		0.5ft.	V w						12	9	3
B w	Brookston loam, 0 to 2 percent slopes	9.60	1.6%		1ft.	IIw						76	73	75
LmC2	Lapeer sandy loam, 6 to 12 percent slopes, moderately eroded	8.69	1.5%		> 6.5ft.	Ile		105	27		45	56	56	42
Lm	Linwood muck	8.41	1.4%		0ft.	V w						14	4	3
TsB	Tuscola loam, 2 to 6 percent slopes	7.56	1.3%		> 6.5ft.	Ile		132	35		66	68	68	56
BrC	Boyer loamy sand, 6 to 12 percent slopes	6.90	1.2%		> 6.5ft.	IIIe		75	26		32	56	56	30
WeB	Wasepi sandy loam, 2 to 6 percent slopes	4.87	0.8%		1.5ft.	IIIe		126	35		60	57	57	33
LmB	Lapeer sandy loam, 2 to 6 percent slopes	4.01	0.7%		> 6.5ft.	Ile		115	30		50	60	60	48
BmC	Boyer loamy sand, 6 to 12 percent slopes	3.49	0.6%		> 6.5ft.	IIIe		82	26		35	47	47	24

Code	Soil Description	Acres	Percent of field	Non-Irr Class Legend	Water Table	Non-Irr Class *c	Irr Class *c	Corn Bu	Soybeans Bu	Soybeans Tons	Winter wheat Bu	*n NCCPI Overall	*n NCCPI Corn	*n NCCPI Soybeans
Gg	Gilford sandy loam, 0 to 2 percent slopes, gravelly subsoil	3.42	0.6%		3.5ft.	llw		149	42		59	49	37	21
MIB	Metamora sandy loam, 0 to 4 percent slopes	2.58	0.4%		1.5ft.	lle		125	40		60	76	76	71
SvB	Spinks-Oakville loamy sands, 0 to 6 percent slopes	2.43	0.4%		> 6.5ft.	IVs		80	25		30	51	51	31
SpB	Spinks loamy sand, 2 to 6 percent slopes	2.39	0.4%		> 6.5ft.	lls	lls	88	25		33	52	52	30
MeB	Metamora sandy loam, 2 to 6 percent slopes	2.31	0.4%		1.5ft.	lle		136	40		66	75	75	68
MxB	Miami-Conover loams, 2 to 6 percent slopes	1.95	0.3%		1.5ft.	lle		120	35		60	80	79	76
MmB	Matherton sandy loam, 2 to 6 percent slopes	1.83	0.3%		3ft.	llle		126	33		55	67	67	46
OkA	Ottokee loamy sand, 0 to 2 percent slopes	1.51	0.3%		3ft.	IVs		88	25		33	54	54	32
MuC2	Wawasee loam, 6 to 12 percent slopes, moderately eroded	1.42	0.2%		> 6.5ft.	llle						54	54	51
BsA	Boyer loamy sand, silty substratum, 0 to 2 percent slopes	1.27	0.2%		> 6.5ft.	lls		80				67	67	44
SpC	Spinks loamy sand, 6 to 12 percent slopes	1.15	0.2%		> 6.5ft.	llle	llle					54	54	31
MoB	Wawasee loam, 2 to 6 percent slopes	0.93	0.2%		> 6.5ft.	lle						59	59	55
BsB	Boyer loamy sand, silty substratum, 2 to 6 percent slopes	0.65	0.1%		> 6.5ft.	lls		80				66	66	43
Sd	Sebewa loam, 0 to 2 percent slopes	0.53	0.1%		0ft.	llw						78	73	77
OmB	Owosso-Miami sandy loams, 2 to 6 percent slopes	0.48	0.1%		> 6.5ft.	lle		115	35		55	71	70	66



Code	Soil Description	Acres	Percent of field	Non-Irr Class Legend	Water Table	Non-Irr Class *c	Irr Class *c	Corn Bu	Soybeans Bu	Soybeans Tons	Winter wheat Bu	*n NCCPI Overall	*n NCCPI Corn	*n NCCPI Soybeans
TsB	Tuscola loam, 2 to 6 percent slopes	0.14	0.0%		6.5ft. >	Ile		132	35		66	68	68	56
LdB	Lapeer sandy loam, 2 to 6 percent slopes	0.09	0.0%		6.5ft. >	Ile		115	30		50	60	60	48
KnA	Kibbie loam, 0 to 2 percent slopes	0.08	0.0%		1.5ft.	Ilw		143	40		71	75	72	73
Bh	Berville loam	0.07	0.0%		0ft.	Ilw		154	45		71	72	72	70
Weighted Average						2.61	0.02	74.7	21.6	0.9	33.8	*n 57.3	*n 53.7	*n 44.3

*n: The aggregation method is "Weighted Average using all components"

*c: Using Capabilities Class Dominant Condition Aggregation Method

Soils Map

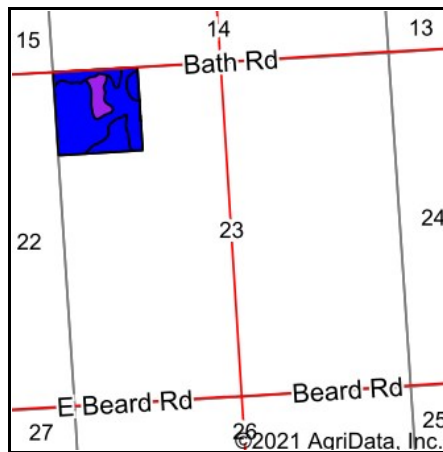
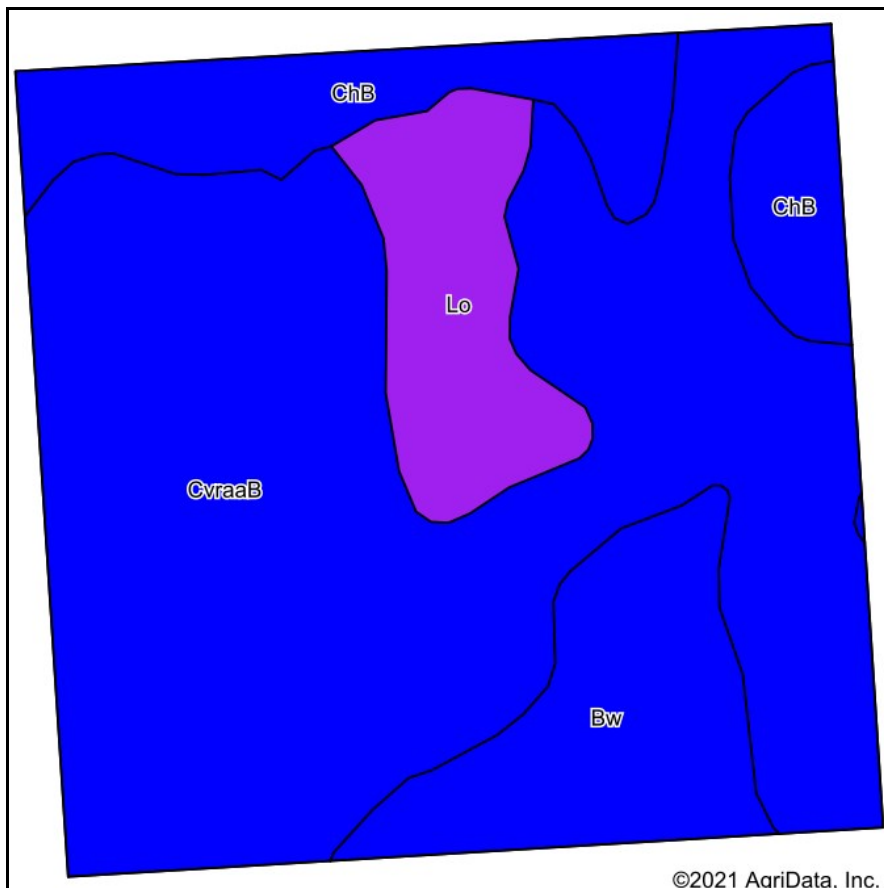

State: **Michigan**
 County: **Shiawassee**
 Location: **23-5N-3E**
 Township: **Antrim**
 Acres: **40.37**
 Date: **12/15/2021**



Soils data provided by USDA and NRCS.

Area Symbol: MI155, Soil Area Version: 19

Code	Soil Description	Acres	Percent of field	Non-Irr Class Legend	Water Table	Non-Irr Class *c	Corn Bu	Soybeans Bu	Winter wheat Bu	*n NCCPI Overall	*n NCCPI Corn	*n NCCPI Soybeans
CvraaB	Conover loam, 0 to 4 percent slopes	26.27	65.1%		1ft.	llw				45	44	36
ChB	Celina loam, 2 to 6 percent slopes	5.52	13.7%		2ft.	lle	132	35	66	81	81	81
B w	Brookston loam, 0 to 2 percent slopes	4.81	11.9%		0ft.	llw				76	73	75
Lo	Linwood muck	3.77	9.3%		0ft.	V w				17	15	16
Weighted Average						2.28	18	4.8	9	*n 51	*n 49.8	*n 44.9

*n: The aggregation method is "Weighted Average using all components"

*c: Using Capabilities Class Dominant Condition Aggregation Method