

Soil Map

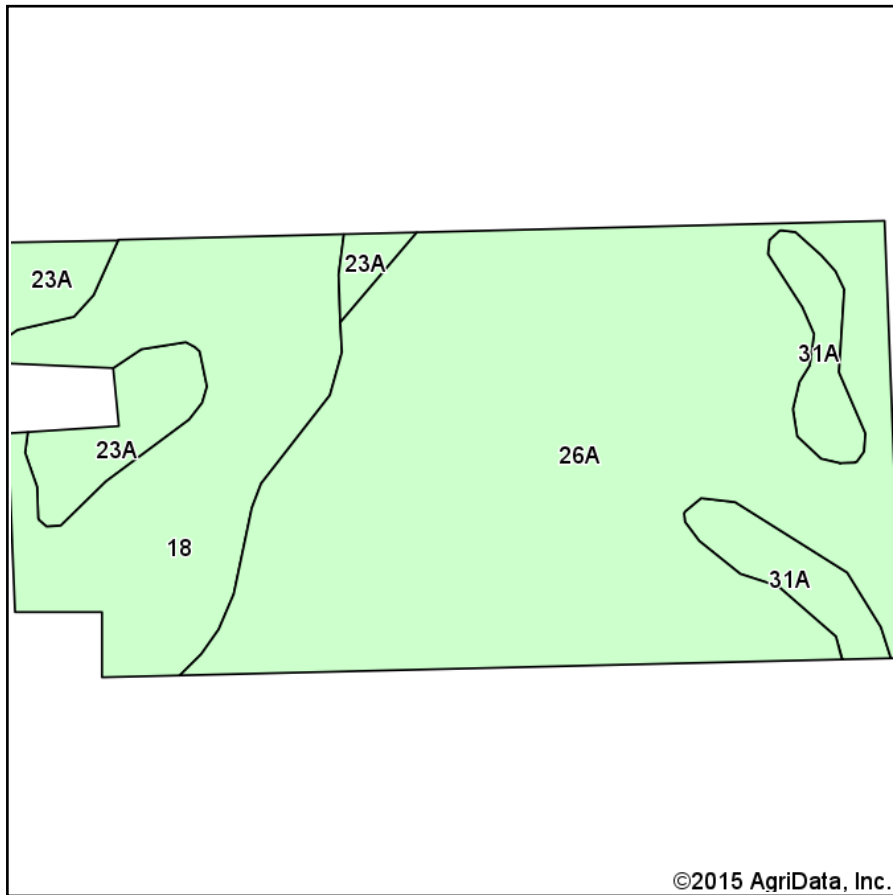

Soils data provided by USDA and NRCS.

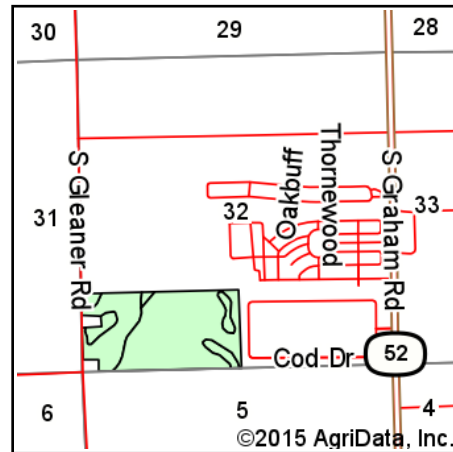

State: **Michigan**
 County: **Saginaw**
 Location: **32-12N-3E**
 Township: **Thomas**
 Acres: **77.05**
 Date: **8/24/2015**

Maps Provided By:

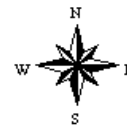

Area Symbol: MI145, Soil Area Version: 13

Code	Soil Description	Acres	Percent of field	Water Table	Restrictive Layer	Soil Drainage	Non-Irr Class *c	Corn	Soybeans	Winter wheat
26A	Pipestone sand, loamy substratum, 0 to 3 percent slopes	49.63	64.4%	0.5ft.	> 6.5ft.	Somewhat poorly drained	IVw	65		30
18	Lenawee silty clay loam	17.51	22.7%	0ft.	> 6.5ft.	Poorly drained	IIIw	130	42	60
23A	Capac loam, 0 to 3 percent slopes	5.28	6.9%	0.5ft.	> 6.5ft.	Somewhat poorly drained	IIw	130	40	65
31A	Pipestone sand, 0 to 3 percent slopes	4.63	6.0%	0.5ft.	> 6.5ft.	Somewhat poorly drained	IVw	65		30
Weighted Average								84.2	12.3	39.2

Area Symbol: MI145, Soil Area Version: 13

*c: Using Capabilities Class Dominant Condition Aggregation Method

Soils data provided by USDA and NRCS.