

Soils Map

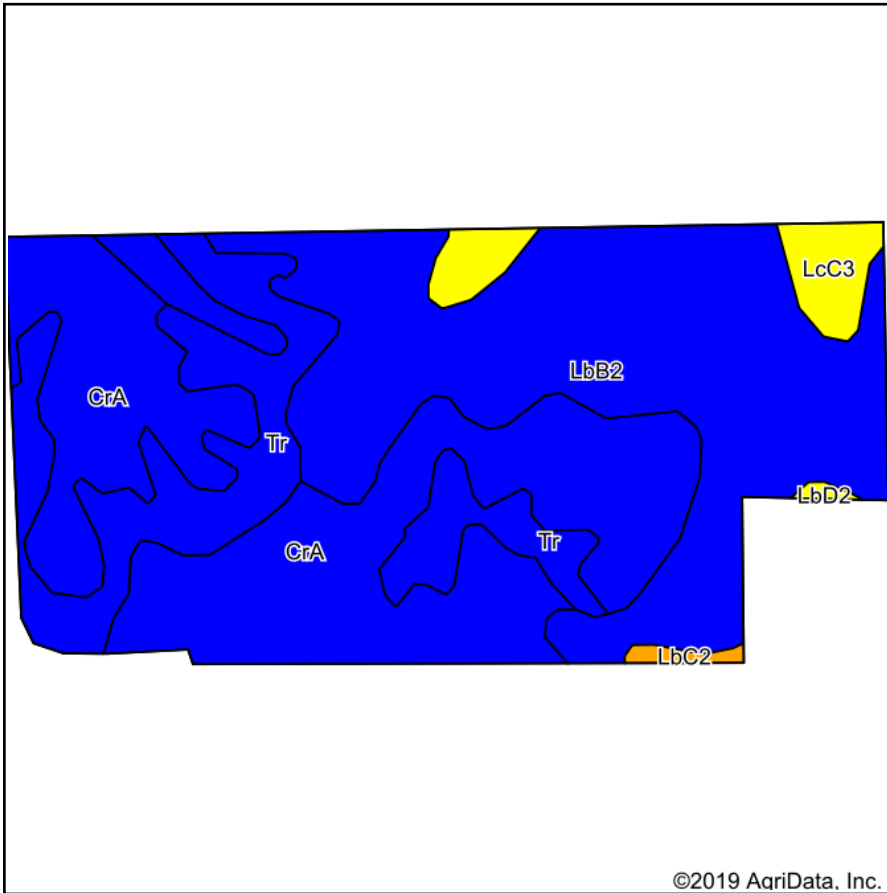

Soils data provided by USDA and NRCS.

©2019 AgriData, Inc.

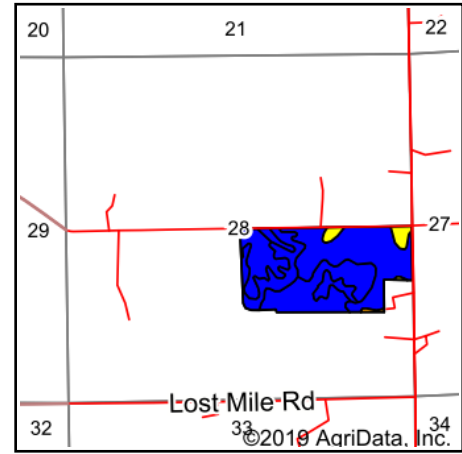

State: **Indiana**
 County: **Wayne**
 Location: **28-17N-12E**
 Township: **Jefferson**
 Acres: **74.05**
 Date: **2/12/2019**



Maps Provided By:



© AgriData, Inc. 2019

www.AgriDataInc.com



Area Symbol: IN177, Soil Area Version: 20

Code	Soil Description	Acres	Percent of field	Non-Irr Class Legend	Soil Drainage	Non-Irr Class *c	Soybeans	Corn
LbB2	Losantville silt loam, 2 to 6 percent slopes, eroded	29.78	40.2%		Moderately well drained	Ile	43	121
CrA	Crosby silt loam, Southern Ohio Till Plain, 0 to 2 percent slopes	28.20	38.1%		Somewhat poorly drained	Ilw	41	123
Tr	Treaty silty clay loam, 0 to 1 percent slopes	12.62	17.0%		Poorly drained	Ilw	51	173
LcC3	Losantville clay loam, 6 to 12 percent slopes, severely eroded	2.94	4.0%		Moderately well drained	IVe	38	111
LbC2	Losantville silt loam, 6 to 12 percent slopes, eroded	0.35	0.5%		Moderately well drained	IIIe	39	111
LbD2	Losantville silt loam, 12 to 18 percent slopes, eroded	0.16	0.2%		Moderately well drained	IVe	34	97
Weighted Average							43.4	130.1

*c: Using Capabilities Class Dominant Condition Aggregation Method

Soils data provided by USDA and NRCS.