

Soils Map

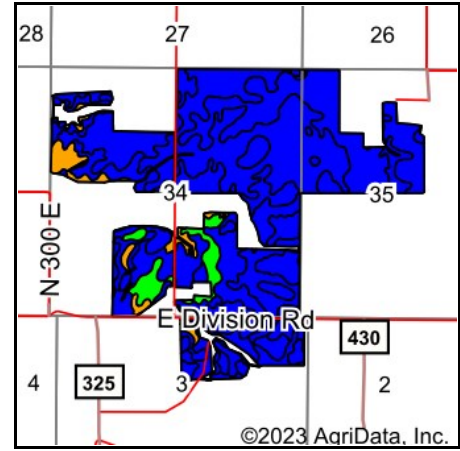

State: **Indiana**
 County: **Fountain**
 Location: **34-20N-7W**
 Township: **Richland**
 Acres: **576.96**
 Date: **3/29/2023**

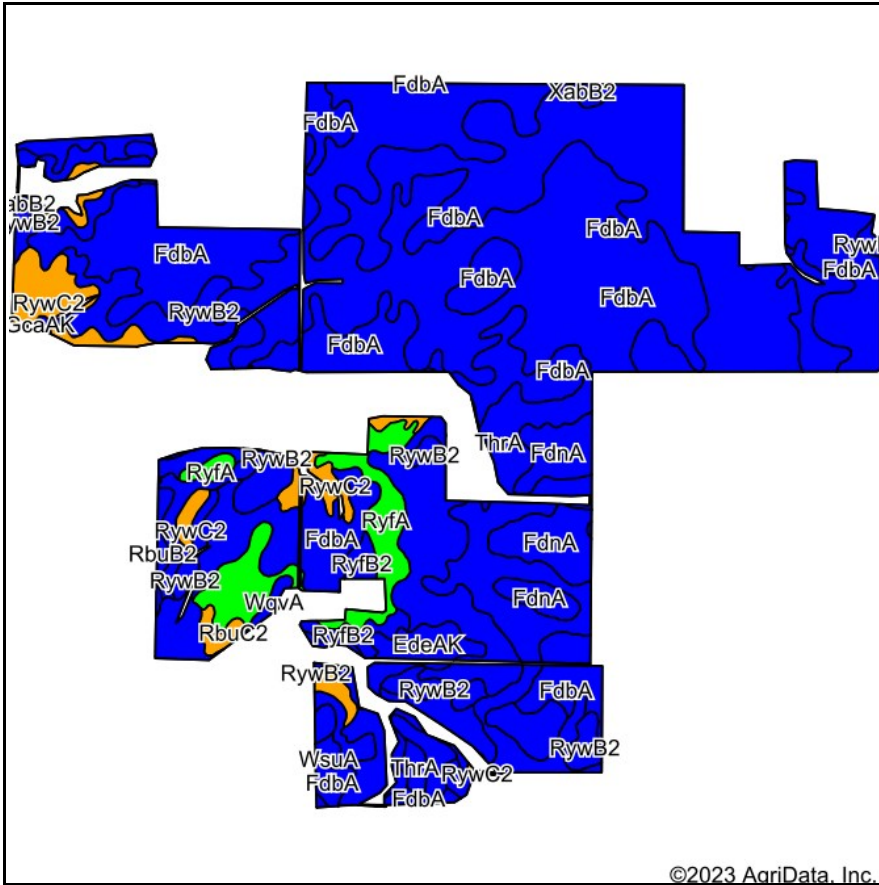

Soils data provided by USDA and NRCS.

©2023 AgriData, Inc.

© AgriData, Inc. 2023

www.AgriDataInc.com

Area Symbol: IN045, Soil Area Version: 23

Code	Soil Description	Acres	Percent of field	Non-Irr Class Legend	Water Table	Restrictive Layer	Soil Drainage	Non-Irr Class *c	Corn Bu	Soybeans Bu	Winter wheat Bu	*n NCCPI Corn	*n NCCPI Soybeans
FdbA	Fincastle silt loam, Tipton Till Plain, 0 to 2 percent slopes	233.65	40.5%		0.5ft.	4.9ft. (Densic material)	Somewhat poorly drained	IIw	168	62	65	90	80
ThrA	Treaty silty clay loam, 0 to 1 percent slopes	185.21	32.1%		0ft.	> 6.5ft.	Poorly drained	IIw	181	64	61	81	76
RywB2	Russell silt loam, 2 to 6 percent slopes, eroded	47.18	8.2%		4.7ft.	4.8ft. (Densic material)	Well drained	Ile	149	53	73	82	68
RyfA	Rush silt loam, 0 to 2 percent slopes	22.09	3.8%		> 6.5ft.	5.1ft. (Strongly contrasting textural stratification)	Well drained	Iw	155	54	77	91	79
FdnA	Fincastle-Starks silt loams, 0 to 2 percent slopes	21.35	3.7%		0.5ft.	4.9ft. (Densic material)	Somewhat poorly drained	IIw	166	54	74	90	78
RywC2	Russell silt loam, 6 to 12 percent slopes, eroded	21.34	3.7%		4.7ft.	4.8ft. (Densic material)	Well drained	IIle	138	48	69	76	58

Code	Soil Description	Acres	Percent of field	Non-Irr Class Legend	Water Table	Restrictive Layer	Soil Drainage	Non-Irr Class *c	Corn Bu	Soybeans Bu	Winter wheat Bu	*n NCCPI Corn	*n NCCPI Soybeans
EdeAK	Eel and Beckville soils, 0 to 2 percent slopes, occasionally flooded, brief duration	13.81	2.4%		1.5ft.	> 6.5ft.	Moderately well drained	Ilw	116	41	50	73	73
WsuA	Whitaker loam, 0 to 2 percent slopes	13.00	2.3%		0.5ft.	> 6.5ft.	Somewhat poorly drained	Ilw	153	51	69	86	77
RbuB2	Rainsville silt loam, 2 to 6 percent slopes, eroded	8.31	1.4%		2.5ft.	4ft. (Densic material)	Moderately well drained	Ile	139	49	62	76	61
RyfB2	Rush silt loam, 2 to 6 percent slopes, eroded	5.58	1.0%		> 6.5ft.	5.1ft. (Strongly contrasting textural stratification)	Well drained	Ile	150	53	74	85	69
RbuC2	Rainsville silt loam, 6 to 12 percent slopes, eroded	2.23	0.4%		2.5ft.	4ft. (Densic material)	Moderately well drained	Ile	126	45	57	75	60
WqvA	Westland silty clay loam, 0 to 2 percent slopes	1.21	0.2%		0.2ft.	3.9ft. (Strongly contrasting textural stratification)	Poorly drained	Ilw	174	49	69	73	70
XabB2	Xenia silt loam, 2 to 6 percent slopes, eroded	1.00	0.2%		1.5ft.	4.8ft. (Densic material)	Moderately well drained	Ile	152	53	68	86	71
GcaAK	Genesee soils, 0 to 2 percent slopes, occasionally flooded, brief duration	0.55	0.1%		> 6.5ft.	> 6.5ft.	Well drained	Ilw	125	44	60	72	78
XfuB2	Miami-Rainsville complex, 2 to 6 percent slopes, eroded	0.45	0.1%		2.5ft.	3ft. (Densic material)	Moderately well drained	Ile	141	49	63	68	52
Weighted Average								2.00	166.5	59.6	65.1	*n 85.1	*n 76.1

*n: The aggregation method is "Weighted Average using all components"

*c: Using Capabilities Class Dominant Condition Aggregation Method